

Worm and wheel set



Module 1.25 Worm in steel or machined plastic



- Pitch 3.927mm
- **Machined parts**
- Pressure angle 20°
- Right handed lead angle
- Materials:
Worm: Steel 20NCD2 or Delrin plastic
Wheel: bronze CuAl10NiFe4 or Delrin plastic
- Delrin: Working temp. -50°C to +80°C



Options

- Left handed lead angle
- **Wheel can have from 12 to 110 teeth**

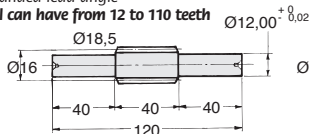

Steel worm with shaft (SW)

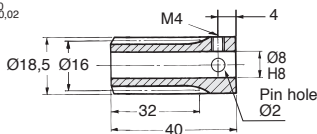

Steel (W) or plastic (ZW) worm with bore

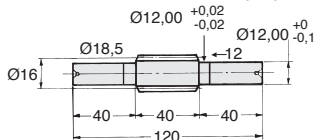

Plastic worm with shaft (ZSW)

DISCOUNT Steel

Qty	1+	6+	20+	50+
Disc.	List -12%	-25%	On request	

DISCOUNT Delrin

Qty	1+	6+	30+
Disc.	List -22%	On request	

Part number		No. of starts	Lead angle	Price each 1 to 5	
Worm with bore	Worm with shaft			Worm with bore	Worm with shaft

Non hardened steel

W1.25-1	SW1.25-1	1	4°28'	37,40 €	69,07 €
W1.25-2	SW1.25-2	2	8°53'	39,58 €	70,95 €
W1.25-3	SW1.25-3	3	13°11'	43,42 €	75,74 €
W1.25-4	SW1.25-4	4	17°21'	45,34 €	76,85 €

Hardened steel

WH1.25-1	SWH1.25-1	1	4°28'	53,29 €	98,15 €
WH1.25-2	SWH1.25-2	2	8°53'	56,24 €	100,85 €
WH1.25-3	SWH1.25-3	3	13°11'	61,67 €	107,55 €
WH1.25-4	SWH1.25-4	4	17°21'	64,45 €	109,17 €

Delrin

ZW1.25-1	ZSW1.25-1	1	4°28'	26,42 €	48,63 €
ZW1.25-2	ZSW1.25-2	2	8°53'	27,80 €	49,89 €
ZW1.25-3	ZSW1.25-3	3	13°11'	30,53 €	53,31 €
ZW1.25-4	ZSW1.25-4	4	17°21'	31,88 €	49,18 €

Dimensions in mm

Wheel in bronze or machined plastic Module 1.25

Info.

- Pitch 3.927mm
- To order, add the number of starts on the worm to the wheel's part number.
E.g: worm **W1.25-1**, wheel **M1.25-20/1**
- The use of a delrin worm with a delrin wheel is only recommended for occasional use. The use of a delrin worm with a steel wheel is preferred.

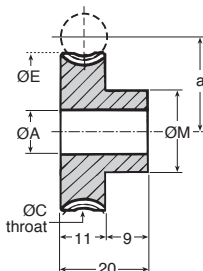

Torque and power indication for 50 teeth at 1000 rpm (input)

WHEEL material	Bronze Nm (kW)	Delrin Nm (kW)
Steel	11.41 (0.024)	7.02 (0.015)
Hardened steel	20.25 (0.042)	-
Delrin	-	2.75 (0.006)

DISCOUNT Bronze

Qty	1+	6+	20+	50+
Disc.	List	-12%	-25%	On request

DISCOUNT Delrin

Qty	1+	6+	30+
Disc.	List	-22%	On request

Part number	Z	Centres a	ØP	ØC	ØE	ØM	ØA	Price each 1 to 5		
								Bronze	Plastic	
M1.25-12	ZM1.25-12	12	15,00	15,50	17,50	18,75	14,00	8	40,90 €	20,56 €
M1.25-15	ZM1.25-15	15	18,75	17,38	21,25	22,50	14,00	8	43,00 €	21,57 €
M1.25-20	ZM1.25-20	20	25,00	20,50	27,50	28,75	20,00	10	41,74 €	24,15 €
M1.25-38	ZM1.25-38	38	47,50	31,75	50,00	51,25	25,00	10	76,24 €	47,96 €
M1.25-45	ZM1.25-45	45	56,25	36,13	58,75	60,00	25,00	10	97,64 €	61,56 €
M1.25-60	ZM1.25-60	60	75,00	45,50	77,50	78,75	32,00	12	162,26 €	102,16 €

Wheels available up to this size		Dimensions : contact us	
M1.25-110	ZM1.25-110	110	On request

Our other products



CHA225

Screwed hinge with threaded insert, 225 degrees



G1

Steel spur gear, Steel 20NCD2



PCS75K

Chain sprocket with hardened teeth, 19.05mm (DIN12B-1)



ACLERP

Roller block for aluminium profile, With guide rail



SUA4

Single chain supplied by the metre, Steel



AC

Strike for toggle latch, 15mm

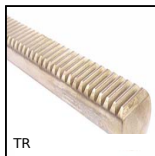

TR

Spur round rack, Stainless steel - module 0,25-1,5



SCA_SS

Stainless steel flat cable clamp, Stainless steel



PPF

Indexing plunger with flange, with drilled flange



UGAC_UGET

Connection for threaded actuator rod, Connection for



BG

Oldham coupling, With set screw



CAP815

Slim slat top chain stainless steel, Narrow range 815

Complementary products



M1

Worm and wheel set, Non hardened steel



M1

Worm and wheel set, Hardened steel