

Worm and wheel set



Module 0.8 Worm in steel or machined plastic

- Pitch 2.513mm
- Machined parts
- Pressure angle 20°
- Right handed lead angle
- Materials:
Worm: Steel 20NCD2 or Delrin plastic
Wheel: bronze CuAl10NiFe4 or Delrin plastic
- Delrin: Working temp. -50°C to +80°C



Options

- Left handed lead angle
- Wheel can have from 12 to 170 teeth

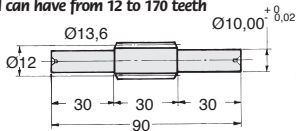

Steel worm with shaft (SW)

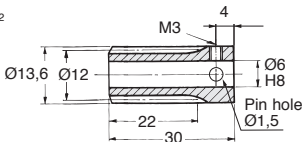

Steel (W) or plastic (ZW) worm with bore

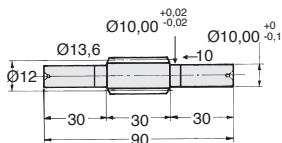

Plastic worm with shaft (ZSW)

DISCOUNT Steel

Qty	1+	6+	20+	50+
Disc.	List -12%	-25%	On request	

DISCOUNT Delrin

Qty	1+	6+	30+
Disc.	List -22%	On request	

Part number		No. of starts	Lead angle	Price each 1 to 5	
Worm with bore	Worm with shaft			Worm with bore	Worm with shaft
Non hardened steel					
W0.8-1	SW0.8-1	1	3°48'	32,47 €	55,93 €
W0.8-2	SW0.8-2	2	7°35'	33,90 €	58,82 €
W0.8-3	SW0.8-3	3	11°18'	36,74 €	61,63 €
W0.8-4	SW0.8-4	4	14°55'	39,82 €	64,45 €
Hardened steel					
WH0.8-1	SWH0.8-1	1	3°48'	46,19 €	79,50 €
WH0.8-2	SWH0.8-2	2	7°35'	48,19 €	83,59 €
WH0.8-3	SWH0.8-3	3	11°18'	52,38 €	87,57 €
WH0.8-4	SWH0.8-4	4	14°55'	49,74 €	91,73 €
Delrin					
ZW0.8-1	ZSW0.8-1	1	3°48'	22,88 €	39,39 €
ZW0.8-2	ZSW0.8-2	2	7°35'	23,84 €	41,34 €
ZW0.8-3	ZSW0.8-3	3	11°18'	25,84 €	43,30 €
ZW0.8-4	ZSW0.8-4	4	14°55'	28,01 €	45,36 €

Dimensions in mm

Wheel in bronze or machined plastic Module 0.8

Info.

- Pitch 2.513mm
- To order, add the number of starts on the worm to the wheel's part number.
E.g: worm **WO.8-1**, wheel **MO.8-20/1**
- The use of a delrin worm with a delrin wheel is only recommended for occasional use. The use of a delrin worm with a steel wheel is preferred.

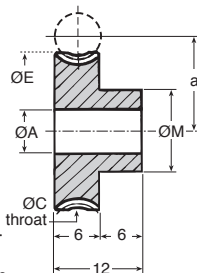

Torque and power indication for 50 teeth at 1000 rpm (input)

WHEEL material	Bronze Nm (kW)	Delrin Nm (kW)
Steel	2.82 (0.006)	1.84 (0.0039)
Hardened steel	5.26 (0.011)	-
Delrin	-	0.70 (0.0015)

DISCOUNT Bronze

Qty	1+	6+	20+	50+
Disc.	List	-12%	-25%	On request

DISCOUNT Delrin

Qty	1+	6+	30+
Disc.	List	-22%	On request

Part number		Z	Centres					Price each 1 to 5		
Bronze	Plastic	Teeth	ØP	a	ØC	ØE	ØM	ØA	Bronze	Plastic
M0.8-12	ZM0.8-12	12	9,60	10,80	11,20	12,00	8	5	23,84 €	11,97 €
M0.8-15	ZM0.8-15	15	12,00	12,00	13,60	14,40	10	5	25,97 €	12,99 €
M0.8-18	ZM0.8-18	18	14,40	13,20	16,00	16,80	10	5	29,03 €	14,57 €
M0.8-20	ZM0.8-20	20	16,00	14,00	17,60	18,40	12	5	29,55 €	14,80 €
M0.8-24	ZM0.8-24	24	19,20	15,60	20,80	21,60	12	5	32,03 €	16,01 €
M0.8-25	ZM0.8-25	25	20,00	16,00	21,60	22,40	16	8	33,70 €	16,92 €
M0.8-28	ZM0.8-28	28	22,40	17,20	24,00	24,80	16	8	34,94 €	17,53 €
M0.8-30	ZM0.8-30	30	24,00	18,00	25,60	26,40	16	8	36,34 €	18,26 €
M0.8-32	ZM0.8-32	32	25,60	18,80	27,20	28,00	16	8	37,63 €	18,93 €
M0.8-40	ZM0.8-40	40	32,00	22,00	33,60	34,40	20	8	44,95 €	24,82 €
M0.8-42	ZM0.8-42	42	33,60	22,80	35,20	36,00	20	8	48,17 €	26,65 €
M0.8-48	ZM0.8-48	48	38,40	25,20	40,00	40,80	20	8	56,14 €	30,98 €
M0.8-50	ZM0.8-50	50	40,00	26,00	41,60	42,40	20	8	60,54 €	38,10 €
M0.8-60	ZM0.8-60	60	48,00	30,00	49,60	50,40	20	8	92,67 €	58,34 €
M0.8-78	ZM0.8-78	78	62,40	37,20	64,00	64,80	20	8	99,64 €	62,75 €
M0.8-80	ZM0.8-80	80	64,00	38,00	65,60	66,40	20	8	100,53 €	63,34 €
M0.8-90	ZM0.8-90	90	72,00	42,00	73,60	74,40	20	8	114,51 €	72,11 €
M0.8-100	ZM0.8-100	100	80,00	46,00	81,60	82,40	20	8	125,68 €	79,11 €
M0.8-110	ZM0.8-110	110	88,00	50,00	89,60	90,40	20	8	154,72 €	97,49 €
M0.8-150	ZM0.8-150	150	120,00	66,00	121,60	122,40	20	8	307,21 €	111,90 €

Wheels available up to this size		Dimensions : contact us	
M0.8-170	ZM0.8-170	170	On request On request

Dimensions in mm

Our other products



F7-P-AM

Multifunction display,
Magnetic band



GAL48_OMNI

Omni-directional
roller, Omni-
directional

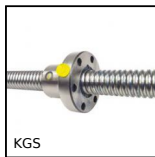

KGS

Ballscrew, supplied by
the metre, Rolled
ballscrew, per metre



PSG085

Spur gear - precision
range, Stainless steel
303



CHAC4040NP

Square hinge with
riveted pin, not
drilled, Square with
riveted pin,...



MHX

Hexagonal threaded
sleeve, Hexagonal -
stainless steel



PW_PWG2

Wheel - precision
range, Bronze



CHN_CHNSS

Straight long link
stainless steel chain,
Stainless steel

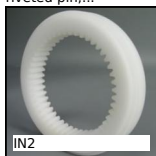

IN2

Internal gear,
Machined plastic
(delrin)

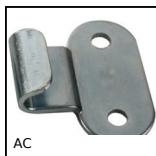

AC

Strike for toggle latch,
20mm



PARF80

Pressed steel base
rigid foot, Swivelling -
Ø80



PO

Pull handle - Multi-
sector, Tapped
recessed insert

Complementary products



M0

Worm and wheel set,
Hardened steel



M0

Worm and wheel set,
Machined plastic
(delrin)



P20

Worm and wheel gear
reducer, up to 5 Nm