

Worm and wheel set



Module 0.4 Worm in steel or machined plastic

- Pitch 1.257mm
- **Machined parts**
- Pressure angle 20°
- Right handed lead angle
- Materials:
Worm: Steel 20NCD2 or Delrin plastic
Wheel: Bronze CuAl10NiFe4 or Delrin plastic
- Delrin: Working temp. -50°C to +80°C



Options

- Left handed lead angle
- **Wheel can have from 20 to 348 teeth**

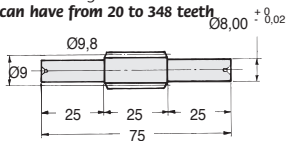

Steel worm with shaft (SW)

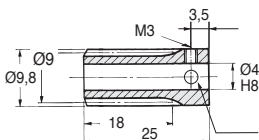

Steel (W) or plastic (ZW) worm with bore

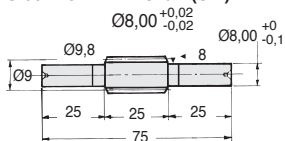

Plastic worm with shaft (ZSW)

DISCOUNT STEEL

Qty	1+	6+	20+	50+
Disc.	List -12%	-25%	On request	

DISCOUNT DELRIN

Qty	1+	6+	30+
Disc.	List -22%	On request	

Part number		No. of starts	Lead angle	Price each 1 to 5	
Worm with bore	Worm with shaft			Worm with bore	Worm with shaft
Non hardened steel					
W0.4-1	SW0.4-1	1	2°32'	29,03 €	53,12 €
W0.4-2	SW0.4-2	2	5°04'	29,44 €	56,87 €
W0.4-3	SW0.4-3	3	7°35'	30,93 €	60,10 €
W0.4-4	SW0.4-4	4	10°40'	33,31 €	61,95 €
Hardened steel					
WH0.4-1	SWH0.4-1	1	2°32'	40,37 €	75,55 €
WH0.4-2	SWH0.4-2	2	5°04'	41,86 €	80,85 €
WH0.4-3	SWH0.4-3	3	7°35'	43,30 €	85,35 €
WH0.4-4	SWH0.4-4	4	10°40'	47,30 €	88,08 €
Plastic					
ZW0.4-1	ZSW0.4-1	1	2°32'	19,94 €	37,53 €
ZW0.4-2	ZSW0.4-2	2	5°04'	20,81 €	40,11 €
ZW0.4-3	ZSW0.4-3	3	7°35'	21,75 €	42,41 €
ZW0.4-4	ZSW0.4-4	4	10°40'	23,41 €	43,75 €

Dimensions in mm

Wheel in bronze or **machined** plastic **Module 0.4**

Info.

- Pitch 1.257mm
- To order, add the number of starts on the worm to the wheel's part number.
E.g: worm **WO.4-1**, wheel **MO.4-20/1**
- The use of a delrin worm with a delrin wheel is only recommended for occasional use. The use of a delrin worm with a steel wheel is preferred.

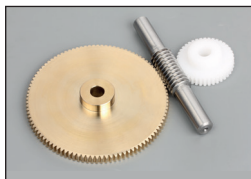
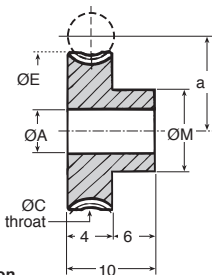

Torque and power indication
for 50 teeth at 1000 rpm (input)

WHEEL material	Bronze	Delrin
WORM material	Nm (kW)	Nm (kW)
Steel	0.57 (0.0012)	0.36 (0.00075)
Hardened steel	1.00 (0.0021)	-
Delrin	-	0.14 (0.00030)

DISCOUNT Bronze

Qty	1+	6+	20+	50+
Disc.	List	-12%	-25%	On request

DISCOUNT Delrin

Qty	1+	6+	30+
Disc.	List	-22%	On request

Part number		Z	Centres						Price each 1 to 5	
Bronze	Delrin	Teeth	ØP	a	ØC	ØE	ØM	ØA	Bronze	Plastic
MO.4-20/1	ZMO.4-20/1	20	8,00	8,50	8,80	9,20	8,80	3	23,84 €	11,97 €
MO.4-24/1	ZMO.4-24/1	24	9,60	9,30	10,40	10,80	10,40	3	24,44 €	12,25 €
MO.4-28/1	ZMO.4-28/1	28	11,20	10,10	12,00	12,40	10,40	3	26,13 €	13,09 €
MO.4-30/1	ZMO.4-30/1	30	12,00	10,50	12,80	13,20	8,00	3	26,68 €	13,35 €
MO.4-34/1	ZMO.4-34/1	34	13,60	11,30	14,40	14,80	8,00	3	27,24 €	13,69 €
MO.4-36/1	ZMO.4-36/1	36	14,40	11,70	15,20	15,60	8,00	3	28,40 €	14,13 €
MO.4-40/1	ZMO.4-40/1	40	16,00	12,50	16,80	17,20	12,00	4	29,38 €	14,72 €
MO.4-45/1	ZMO.4-45/1	45	18,00	13,50	18,80	19,20	12,00	4	29,75 €	14,94 €
MO.4-48/1	ZMO.4-48/1	48	19,20	14,10	20,00	20,40	12,00	4	29,75 €	15,05 €
MO.4-50/1	ZMO.4-50/1	50	20,00	14,50	20,80	21,20	12,00	4	29,75 €	15,18 €
MO.4-62/1	ZMO.4-62/1	62	24,80	16,90	25,60	26,00	12,00	4	29,94 €	15,78 €
MO.4-72/1	ZMO.4-72/1	72	28,80	18,90	29,60	30,00	12,00	5	32,25 €	16,15 €
MO.4-75/1	ZMO.4-75/1	75	30,00	19,50	30,80	31,20	12,00	5	32,41 €	17,90 €
MO.4-84/1	ZMO.4-84/1	84	33,60	21,30	34,40	34,80	12,00	5	34,10 €	18,93 €
MO.4-100/1	ZMO.4-100/1	100	40,00	24,50	40,80	41,20	12,00	5	41,97 €	22,44 €
MO.4-120/1	ZMO.4-120/1	120	48,00	28,50	48,80	49,20	12,00	5	47,32 €	25,99 €
MO.4-130/1	ZMO.4-130/1	130	52,00	30,50	52,80	53,20	12,00	5	54,34 €	28,36 €
MO.4-140/1	ZMO.4-140/1	140	56,00	32,50	56,80	57,20	12,00	5	61,95 €	31,19 €
MO.4-200/1	ZMO.4-200/1	200	80,00	44,50	80,80	81,20	20,00	6	117,17 €	58,95 €
MO.4-300/1	ZMO.4-300/1	300	120,00	64,50	120,80	121,20	20,00	6	273,05 €	99,46 €

Wheels available up to this size		Dimensions : contact us	
MO.4-348	ZMO.4-348	348	On request
			On request

Dimensions in mm

Our other products



SDA

Locking bolt support bracket, Mounting holes parallel to locating bolt



PCF2

Conical flexible mount, Oval base plate



BLHT20

Right angled gearbox, from 0.66 to 1.77 Nm



INS_SS

Self tapping stainless steel insert, 316 stainless steel



CHA5b89

Hinge without pin, Plastic hinge



TIFss

Threaded stud - DIN976A, Stainless steel



E60B

Right angle helical reducers, from 4.50 to 24 Nm

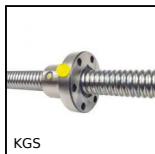

KGS

Ballscrew, supplied by the metre, Rolled ballscrew, per metre



DOMI80

Accessories, Clamping lever



NCT

Square tube connector, Fixed angle

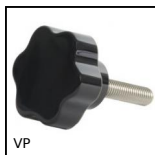

VP

Small 6 lobe threaded handle - male, Duroplast - Steel

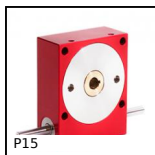

P15

Worm and wheel gear reducer, up to 3,75 Nm

Complementary products