

## LRH 1 right hand start, 1 left hand start

- Lead screw with 1 right hand thread and 1 left hand thread
- Machined trapezoidal thread conforming to BS 5346
- Thread tolerance: 7e
- Material: Half-hard steel



### Uses

- Lathe drive screws
- Other machine tools

**Machined thread**

### Accessories

- Steel and bronze nuts **BFM, VKM, SKM, LRM, KSM**

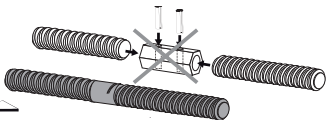
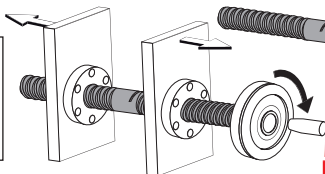
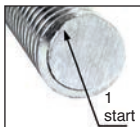
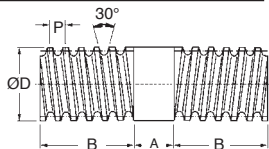

### DISCOUNTS

Qty	1+	5+	10+
Disc.	List	-5%	On request

Part number	ØD	Pitch P (mm)	A (mm)	B (mm)	Stock*	Price each 1 to 4
<b>Length 1000mm</b>						
LRH164-1	16	4	20	490	✓	77,64 €
LRH184-1	18	4	20	490	✓	90,15 €
LRH204-1	20	4	20	490	✓	104,30 €
LRH245-1	24	5	20	490	✓	118,91 €
LRH285-1	28	5	20	490	✓	132,85 €
LRH306-1	30	6	20	490	✓	144,31 €
LRH326-1	32	6	20	490	-	156,62 €
LRH366-1	36	6	20	490	✓	198,36 €
<b>Length 2000mm</b>						
LRH164-2	16	4	20	990	✓	156,72 €
LRH184-2	18	4	20	990	-	181,93 €
LRH204-2	20	4	20	990	✓	210,54 €
LRH245-2	24	5	20	990	✓	239,90 €
LRH285-2	28	5	20	990	✓	267,89 €
LRH306-2	30	6	20	990	✓	291,02 €
LRH326-2	32	6	20	990	-	315,79 €
LRH366-2	36	6	20	990	-	399,95 €

\*Depending on availability - Dimensions in mm

## Our other products



ASM  
Cylindrical polymer bush, Food grade polymer



PAMF80EB  
Articulated foot with sheet metal base Ø80, Articulated foot



DOMI30  
Accessories, Turntable



H02SS  
Needle roller universal joint - Stainless steel, Heavy duty DIN808-7...



H02  
Single needle roller universal joint, Heavy duty



UFX  
Spare tyre UNEFLEX® coupling, range



VTLM  
3 lobed handle, Polyamide - Steel



SH4  
Parallel axis helical gear, Steel 20NCD2



PDM\_PDV  
Detectable plastic palm grip, blue thermoplastic



DILC  
Indexing plunger with cam, with cam



SH1  
Parallel axis helical gear, Steel 20NCD2



B3PAN  
Panamech, Multi-Beam stainless steel, Stainless steel - with clampin...

## Complementary products



BFM  
Flanged bronze nut, Bronze - 1 thread



LRM  
Trapezoidal bronze nut, Bronze - 1 thread