

- Miniature slide bearing
- Material: steel

Assembly

- Recommended tolerances:
Standard assembly
Shaft: $6\mu\text{m}$ / $-14\mu\text{m}$
Housing: 0 / $+12\mu\text{m}$
Precise assembly
Shaft: $-4\mu\text{m}$ / $-9\mu\text{m}$
Housing: 0 / $+8\mu\text{m}$
- Depth of hardening: min. 0.8mm
- Surface hardness: HRC 58-64
- Surface roughness: min. Ra 0.8 μm

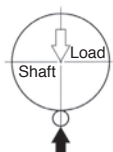
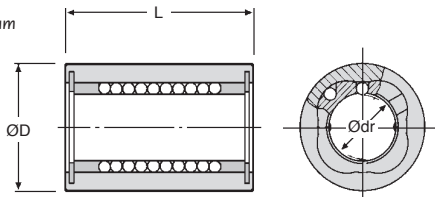

Load in direction A
Case A

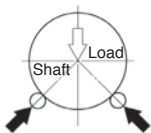

Load in direction B
Case B

DISCOUNTS

Qty	1+	6+	20+
Disc.	List	-10%	On request

Part number	Shaft Ø (mm)	No. of ball tracks	Weight (g)	Max. eccentricity (µm)	Basic dynamic load - C		Basic static load - CO	
					Case A (N)	Case B (N)	Case A (N)	Case B (N)
LBE3M	3	4	1,8	4	18,40	21,20	39,40	55,80
LBE4M	4	4	2,8	4	23,50	27,00	48,60	68,70
LBE5M	5	4	3,8	4	51,30	53,00	108,00	152,00

Part number	Ødr Tolerance (µm)	ØD Tolerance (µm)	L Tolerance (µm)	Stock*	Price each 1 to 5
LBE3M	3 ⁺⁰ ₋₈	7 ⁺⁰ ₋₈	10 ⁺⁰ ₋₁₂₀	✓	33,51 €
LBE4M	4 ⁺⁰ ₋₈	8 ⁺⁰ ₋₈	12 ⁺⁰ ₋₁₂₀	✓	31,34 €
LBE5M	5 ⁺⁰ ₋₈	10 ⁺⁰ ₋₈	15 ⁺⁰ ₋₁₂₀	✓	30,55 €

*Depending on availability - Dimensions in mm

Our other products



PTCR

Adjustable furniture
foot, square tube



PM2

Worm and wheel set,
Machined plastic
(delrin)



GP

Spring loaded toggle
latch, With padlock-
holder



SMS

Spiral bevel gear, 1:1



SBF

Sealed flange bearing
unit for Food Industry,
cover



EX

Optional shaft for E-
type gear reducers, E
Gearboxes double
sided out...



TIF

Threaded rod -
DIN975, Stainless
steel A2



RBN

Wheel, Rubber tyre -
Polypropylene rim



ACLEPP

Right angled bracket
for aluminium profile,



PRF_ART

Articulated bracket for
use with aluminium



AC144

Strike for toggle latch,
22mm



R206

Die spring ISO10243,
Extra-heavy

Complementary products



KB_WW

Closed linear
precision bearing,
Economy range



KB_UU

Closed linear
precision bearing,
Precision - steel