

Sta Adjustable **stainless steel** cam lever

With external thread

LACTss

- Element of manual blocking
- Quick fixing
- Materials

Handle: stainless steel Z6CN18.10M, electrolytically polished
 Thrust washer: glass fibre reinforced black plastic PA 6 GF 30
 Hinge pin, threaded stud and washer: polished stainless steel 303

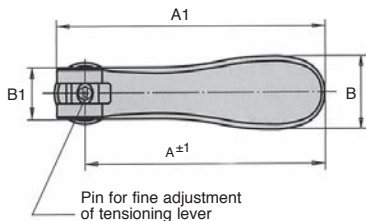
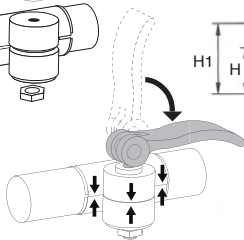
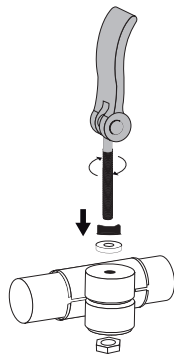

Pin for fine adjustment of tensioning lever

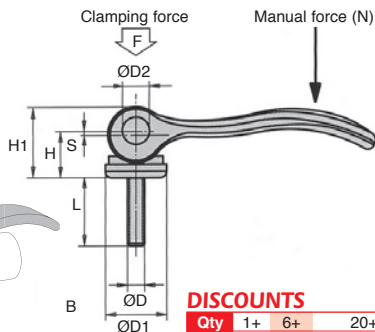

DISCOUNTS

Qty	1+	6+	20+
Disc.	List	-10%	On request

Part number	Thread			B	B1	H	H1	A	A1	Clamping force F (kN)	Manual force N	Stroke S	L	Stock*	Price each 1 to 5
	ØD	ØD1	ØD2												
LAC-T5/SS	M5	18	9	21,5	15	14,5	22,0	70,4	79,2	4	120	1,2	40	✓	30,40 €
LAC-T6/SS	M6	18	9	21,5	15	14,5	22,0	70,4	79,2	4	120	1,2	40	✓	30,40 €
LAC-T8/SS	M8	27	11	33,2	24	18,0	28,5	96,0	108,0	8	350	1,5	50	✓	41,04 €
LAC-T10/SS	M10	27	11	33,2	24	18,0	28,5	96,0	108,0	8	350	1,5	50	✓	41,04 €

*Depending on availability - Dimensions in mm

Our other products



BAC110

Swivel storage bin,
Adjustable support



CLSCLP

Clevis components,
short version, Steel -
short range



E30

Right angle helical
reducers, from 1.50 to
9 Nm



NK27

Drylin®N miniature
guiding system, Width
27 mm



VB

Small 6 lobe threaded
handle - female,
Duroplast - Brass

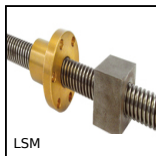

LSM

Stainless steel 316L
leadscrew, Stainless
steel - 1 thread



NDS14C

Angular connector,
Universal angular
connector



RJA00_28

Sealing strip, Clipping



PCLA_T

Technopolymer
clamping lever - male,



MEP

Revolving handle for
handwheel, Fixed



H1

Crossed helical gear
crossed axis at 90°,



M1

Worm and wheel set,
Non hardened steel

Complementary products



LACM_SS

Stainless steel cam
lever, Female