

# Bearing locknut



## KM

## To be used with MB washers

- Frequently used when mounting bearings
- To be used with MB washers
- Absolutely secure, not removable
- Requires machining of keyway in threaded part of the shaft
- Material: steel

For axial locking



### Accessories

- MB washer

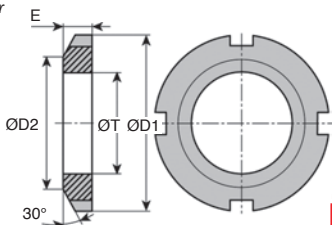

Until  
**-30%\***

### DISCOUNTS

| Qty   | 1+   | 10+  | 20+  | 50+        |
|-------|------|------|------|------------|
| Disc. | List | -30% | -50% | On request |

| Part number | For washer | Thread   | ØT  | ØD1 | ØD2 | E    | Weight (g) | Stock*  | Price each 1 to 9 |
|-------------|------------|----------|-----|-----|-----|------|------------|---------|-------------------|
| KM3         | MB3        | M17x1,0  | 28  | 24  | 5   | 13   | ✓          | 2,18 €  |                   |
| KM4         | MB4        | M20x1,0  | 32  | 26  | 6   | 19   | ✓          | 1,79 €  |                   |
| KM5         | MB5        | M25x1,5  | 38  | 32  | 7   | 25   | ✓          | 2,85 €  |                   |
| KM6         | MB6        | M30x1,5  | 45  | 38  | 7   | 43   | ✓          | 2,36 €  |                   |
| KM7         | MB7        | M35x1,5  | 52  | 44  | 8   | 53   | ✓          | 3,48 €  |                   |
| KM8         | MB8        | M40x1,5  | 58  | 50  | 9   | 85   | ✓          | 4,42 €  |                   |
| KM9         | MB9        | M45x1,5  | 65  | 56  | 10  | 120  | ✓          | 4,42 €  |                   |
| KM10        | MB10       | M50x1,5  | 70  | 61  | 11  | 150  | ✓          | 4,91 €  |                   |
| KM11        | MB11       | M55x2,0  | 75  | 67  | 11  | 160  | ✓          | 6,07 €  |                   |
| KM12        | MB12       | M60x2,0  | 80  | 73  | 11  | 170  | ✓          | 6,38 €  |                   |
| KM13        | MB13       | M65x2,0  | 85  | 79  | 12  | 200  | ✓          | 8,57 €  |                   |
| KM14        | MB14       | M70x2,0  | 92  | 85  | 12  | 240  | -          | 9,24 €  |                   |
| KM15        | MB15       | M75x2,0  | 98  | 90  | 13  | 290  | -          | 9,73 €  |                   |
| KM16        | MB16       | M80x2,0  | 105 | 95  | 15  | 400  | ✓          | 12,59 € |                   |
| KM17        | MB17       | M85x2,0  | 110 | 102 | 16  | 450  | -          | 15,45 € |                   |
| KM18        | MB18       | M90x2,0  | 120 | 108 | 16  | 560  | -          | 17,86 € |                   |
| KM19        | MB19       | M95x2,0  | 125 | 113 | 17  | 660  | -          | 18,17 € |                   |
| KM20        | MB20       | M100x2,0 | 130 | 120 | 18  | 700  | -          | 22,59 € |                   |
| KM22        | MB22       | M110x2,0 | 145 | 133 | 19  | 970  | -          | 27,69 € |                   |
| KM24        | MB24       | M120x2,0 | 155 | 138 | 20  | 1080 | -          | 37,42 € |                   |
| KM26        | MB26       | M130x2,0 | 165 | 149 | 21  | 1250 | -          | 48,05 € |                   |
| KM28        | MB28       | M140x2,0 | 180 | 160 | 22  | 1560 | -          | 53,90 € |                   |
| KM30        | MB30       | M150x2,0 | 195 | 171 | 25  | 2030 | -          | 61,63 € |                   |

\*Depending on availability - Dimensions in mm

## Our other products

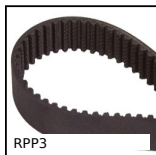

RPP3  
RPP heavy duty timing belt, RPP3



CLSLCP\_SS  
Clevis components, short version, Stainless steel - short range



HG6-ECO  
Eco range Spur gear, Steel C45



RIMple  
Locking castor, with mounting plate

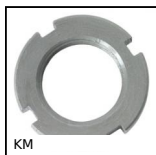

KM  
Bearing locknut, Locknut KM



MSP38  
Masterplate® glueable insert Ø38, Cylindrical Ø38 with threaded s...



CABPVC  
PVC covered galvanised steel cable, Galvanised steel with



M0  
Worm and wheel set, Bronze



RURp  
Fixed castor with plate, Polyurethane - Aluminium rim (Free



VB  
Small 6 lobe threaded handle - female, Duroplast - Brass



G0  
Steel spur gear, Steel 20NCD2



RPCplss  
Fixed castor with plate, Stainless steel - Polyamide

## Complementary products

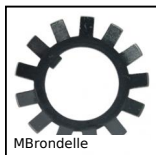

MBrondelle  
Stop washer, Stop washer MB



LR  
Precision locknut, Precision locknut



Q6  
Deep groove ball bearing, Steel