



Linear bearing with inclined ball tracks

High temperature, Heavy load

KKP

- A linear bearing with an inclined ball track suitable for heavy loads.
- Working temperature range: -20 to +200°C
- Can be used with only a light lubrication
- Sealing joints included
- Materials:
 - Outer housing and balls: steel
 - Raceway: bronze
 - Seal: VITON®

Advantages

- Higher working load compared to standard bearings
- No risk of marking the shaft
- Suitable for high temperatures

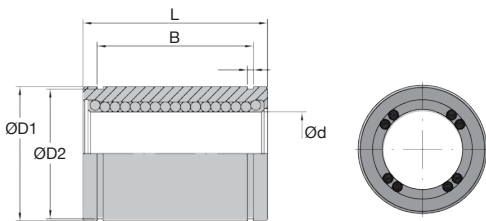

DISCOUNTS

Qty	1+	5+	10+	25+
Disc.	List	-6%	-12%	On request

Part N°	ød	ØD1	L	B	W	øD2	Load		Weight (g)	Price each
							C(N)	Co(N)		
KKP-12AR	12 ^{0/+0,008}	22 ^{0/+0,008}	32 ^{0/-0,2}	22,9 ^{0/-0,2}	1,3	21	670	1210	52	104,55 €
KKP-16AR	16 ^{0/+0,009}	26 ^{0/+0,009}	36 ^{0/-0,2}	24,9 ^{0/-0,2}	1,3	24,9	880	1690	75	117,01 €
KKP-20AR	20 ^{0/+0,009}	32 ^{0/+0,009}	45 ^{0/-0,2}	31,5 ^{0/-0,2}	1,6	30,3	1500	3050	140	125,82 €
KKP-25AR	25 ^{0/+0,011}	40 ^{0/+0,011}	58 ^{0/-0,3}	44,1 ^{0/-0,3}	1,85	37,5	1920	4350	298	169,34 €
KKP-30AR	30 ^{0/+0,011}	47 ^{0/+0,011}	68 ^{0/-0,3}	52,1 ^{0/-0,3}	1,85	44,5	3110	7760	445	226,42 €
KKP-40AR	40 ^{0/+0,013}	62 ^{0/+0,013}	80 ^{0/-0,3}	60,6 ^{0/-0,3}	2,15	59	3400	8940	1025	282,24 €

All dimensions in mm

0 825 88 6000
Service 0,15 € / min
+ prix appel

Fax

cial2@hpceurope.com

HPC

SUPPLEMENT 2019

117

Our other products



T5P_T10P

Connecting plate for T type timing belts, T10



PRF_FIX_UNI

Universal fastener for aluminium profile, Universal



CABPVC

PVC covered galvanised steel cable, Galvanised steel with



CHTRB

Single and dual output gearboxes, Up to 4,7 Nm



PMB

Anti-vibration machine mount, Oval base plate



SH0

Parallel axis helical gear, Machined plastic (delrin)



CHM90

Worm and wheel gear reducer, up to 540 Nm

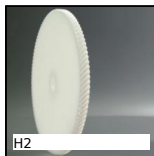

H2

Crossed helical gear crossed axis at 90°, Machined plastic (delrin)



TCC_SS

Stainless steel rigging screw (hook/hook),



KBS_UU

Stainless steel closed precision linear



YG2

HEAVY DUTY spur gear, Steel 35NCD6



GAC

Latch clamp with lock, Lockable

Complementary products



KKB-AR

Linear bearing with inclined ball tracks, Standard loads / -20° +20...



ZA

Shaft for linear guides, Hardened ground steel



ZB

Shaft for linear guides, Hardened ground stainless steel



KB_UU

Closed linear precision bearing, Precision - steel