

- Bearing with solid external ring
- For linear guiding
- Closed construction
- Radial backlash cannot be adjusted
- Easy to install
- Very good guiding precision
- Integrated seals
- Working temperature:
steel/polyamide: -20°C to +80°C
steel/steel: -20°C/+110°C
- Materials:
Body: Steel 100C6
Balls: Steel 70 HRC ±2
Raceway: Steel or polyamide

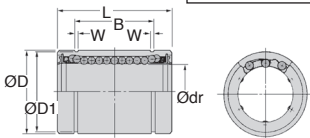

Info.

- Should only be used with Z-A or Z-B hardened and ground shafts

DISCOUNTS

Qty	1+	5+	10+	25+
Disc.	List	-6%	-12%	On request

Part number	Ødr	ØD	L	B	W	ØD1	Loads		Stock*	Price each 1 to 4
							Dynamic C (N)	Static C (N)		
With steel raceway										
KB-5-UU	5 ^{-0.008} / _{+0.008}	12 ^{+0.000} / _{-0.008}	22 ^{+0.0} / _{-0.2}	14,5 ^{+0.0} / _{-0.2}	1,10	11,50	206	265	✓	44,80 €
KB-8-UU	8 ^{-0.000} / _{+0.008}	16 ^{+0.000} / _{-0.008}	25 ^{+0.0} / _{-0.2}	16,5 ^{+0.0} / _{-0.2}	1,10	15,20	265	402	✓	27,08 €
KB-10-UU	10 ^{-0.000} / _{+0.008}	19 ^{+0.000} / _{-0.009}	29 ^{+0.0} / _{-0.2}	22,0 ^{+0.0} / _{-0.2}	1,30	18,00	372	549	✓	28,75 €
KB-12-UU	12 ^{-0.000} / _{+0.008}	22 ^{+0.000} / _{-0.009}	32 ^{+0.0} / _{-0.2}	22,9 ^{+0.0} / _{-0.2}	1,30	21,00	510	784	✓	30,90 €
KB-16-UU	16 ^{-0.001} / _{+0.009}	26 ^{+0.000} / _{-0.009}	36 ^{+0.0} / _{-0.2}	24,9 ^{+0.0} / _{-0.2}	1,30	24,90	578	892	✓	36,98 €
KB-20-UU	20 ^{-0.001} / _{+0.009}	32 ^{+0.000} / _{-0.011}	45 ^{+0.0} / _{-0.2}	31,5 ^{+0.0} / _{-0.2}	1,60	30,30	862	1370	✓	44,55 €
KB-25-UU	25 ^{-0.011} / _{+0.011}	40 ^{+0.000} / _{-0.011}	58 ^{+0.0} / _{-0.3}	44,1 ^{+0.0} / _{-0.3}	1,85	37,50	980	1570	✓	59,32 €
KB-30-UU	30 ^{-0.001} / _{+0.011}	47 ^{+0.000} / _{-0.011}	68 ^{+0.0} / _{-0.3}	52,1 ^{+0.0} / _{-0.3}	2,15	44,50	1570	2740	✓	77,46 €
KB-40-UU	40 ^{-0.002} / _{+0.013}	62 ^{+0.000} / _{-0.013}	80 ^{+0.0} / _{-0.3}	60,6 ^{+0.0} / _{-0.3}	2,15	59,00	2160	4020	✓	127,83 €
KB-60-UU	60 ^{-0.002} / _{+0.013}	90 ^{+0.000} / _{-0.015}	125 ^{+0.0} / _{-0.4}	101,7 ^{+0.0} / _{-0.4}	3,15	72,00	4700	9800	-	280,02 €
KB-80-UU	80 ^{-0.004} / _{+0.018}	120 ^{+0.000} / _{-0.015}	165 ^{+0.0} / _{-0.4}	133,7 ^{+0.0} / _{-0.4}	4,15	116,00	7350	16000	-	554,79 €
With polyamide raceway										
KB-5-UUG	5 ^{-0.008} / _{+0.008}	12 ^{+0.000} / _{-0.008}	22 ^{+0.0} / _{-0.2}	14,5 ^{+0.0} / _{-0.2}	1,10	11,50	206	265	✓	19,49 €
KB-8-UUG	8 ^{-0.000} / _{+0.008}	16 ^{+0.000} / _{-0.008}	25 ^{+0.0} / _{-0.2}	16,5 ^{+0.0} / _{-0.2}	1,10	15,20	265	402	✓	17,65 €
KB-10-UUG	10 ^{-0.000} / _{+0.008}	19 ^{+0.000} / _{-0.009}	29 ^{+0.0} / _{-0.2}	22,0 ^{+0.0} / _{-0.2}	1,30	18,00	372	549	✓	18,27 €
KB-12-UUG	12 ^{-0.000} / _{+0.008}	22 ^{+0.000} / _{-0.009}	32 ^{+0.0} / _{-0.2}	22,9 ^{+0.0} / _{-0.2}	1,30	21,00	510	784	✓	18,87 €
KB-16-UUG	16 ^{-0.001} / _{+0.009}	26 ^{+0.000} / _{-0.009}	36 ^{+0.0} / _{-0.2}	24,9 ^{+0.0} / _{-0.2}	1,30	24,90	578	892	✓	23,73 €
KB-20-UUG	20 ^{-0.001} / _{+0.009}	32 ^{+0.000} / _{-0.011}	45 ^{+0.0} / _{-0.2}	31,5 ^{+0.0} / _{-0.2}	1,60	30,30	862	1370	✓	31,08 €
KB-25-UUG	25 ^{-0.011} / _{+0.011}	40 ^{+0.000} / _{-0.011}	58 ^{+0.0} / _{-0.3}	44,1 ^{+0.0} / _{-0.3}	1,85	37,50	980	1570	-	42,07 €
KB-30-UUG	30 ^{-0.001} / _{+0.011}	47 ^{+0.000} / _{-0.011}	68 ^{+0.0} / _{-0.3}	52,1 ^{+0.0} / _{-0.3}	2,15	44,50	1570	2740	✓	56,12 €
KB-40-UUG	40 ^{-0.002} / _{+0.013}	62 ^{+0.000} / _{-0.013}	80 ^{+0.0} / _{-0.3}	60,6 ^{+0.0} / _{-0.3}	2,15	59,00	2160	4020	-	87,87 €
KB-50-UUG	50 ^{-0.002} / _{+0.013}	75 ^{+0.000} / _{-0.013}	100 ^{+0.0} / _{-0.3}	77,6 ^{+0.0} / _{-0.3}	2,65	72,00	3820	7940	-	140,39 €
KB-60-UUG	60 ^{-0.002} / _{+0.013}	90 ^{+0.000} / _{-0.015}	125 ^{+0.0} / _{-0.4}	101,7 ^{+0.0} / _{-0.4}	3,15	86,50	4700	9800	-	185,65 €

*Depending on availability - Dimensions in mm

Our other products



CHM75

Worm and wheel gear reducer, up to 298 Nm



BPLE

Ball transfer unit push fit, Light



BABpss

301 Stainless steel ball pin, Stainless steel

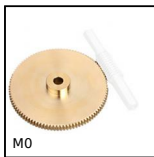

M0

Worm and wheel set, Bronze



BFM2

Flanged bronze nut, Bronze - 2 threads

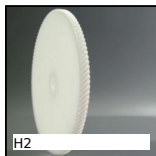

H2

Crossed helical gear crossed axis at 90°, Machined plastic (delrin)

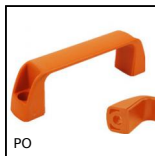

PO

Pull handle - Multi-sector, Smooth hole



MHXred

Reducing sleeve male/female, Hexagonal - stainless steel



SSB

Stainless steel bevel gear, 1:1



SLS

Bearing block for leadscrew, Floating



PTA150

Articulated levelling foot, pressed base



ZHBRA

Plastic bevel gear, 1,25:1 2:1 3:1

Complementary products



ZA

Shaft for linear guides, Hardened ground steel



ZB

Shaft for linear guides, Hardened ground stainless steel



KKB-AR

Linear bearing with inclined ball tracks, Standard loads / -20° +20...



KKP-AR

Linear bearing with inclined ball tracks, Heavy loads / -20° +200°