

Self tapping steel insert

Stock Ste

INS

For hard materials

- Self tapping insert with fine external thread
- Material: hardened steel, zinc bichromate finish

Applications

- For use with aluminium or other non ferrous metals, thermoplastics and hardwoods

Mounting

- Mount the insert in a plain hole with the aid of the insertion tool INS-TOOL, a tap, a drill fitted with a threaded head or an automatic threading machine.
- The insert should be installed in such a way that the thread/slot cuts its own thread
- For soft material the initial hole should be drilled at the minimum recommended size, for a hard material, at the maximum recommended size

Info.

- Sold by the packet

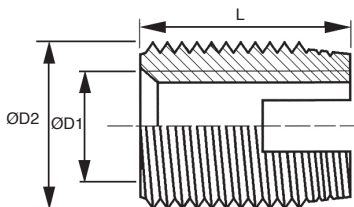

Excellent resistance to being extracted

DISCOUNTS

Qty	1+	10+	20+	30+	40+
Disc.	List	-5%	-10%	-15%	On request

Part number	Internal thread ØD1	External thread ØD2	Length L	Recommended drill size mini	Recommended drill size maxi	Qty per packet	Stock*	Price per packet
INS300-M3/B	M3	M5 X 0,5	6	4,6	4,8	20	✓	10,27 €
INS300-M4/B	M4	M6,5 X 0,75	8	5,8	6,2	20	✓	13,99 €
INS300-M5/B	M5	M8 X 1	10	7,1	7,6	20	✓	15,37 €
INS300-M6/B	M6	M10 X 1,5	14	8,6	9,4	20	✓	18,36 €
INS300-M8/B	M8	M12 X 1,5	15	10,6	11,4	20	✓	22,65 €
INS300-M10/B	M10	M14 X 1,5	18	12,6	13,4	15	✓	30,35 €
INS300-M12/B	M12	M16 X 1,5	22	14,6	15,4	10	✓	36,45 €

*Depending on availability - Dimensions in mm

Our other products



UCP_SS
Pillow block, Stainless steel



GTCSS
Belt tension rollers,
For use in hostile environments



CLG25-ALI
Spur gear, Moulded blue plastic (nylon)



NDS20
Double cross clamp, Parallel



GB0
Spur gear, Brass CuZn40Pb3



GBMf
Ball screw, Flanged nut - Multiple starts



WING
Manually tightened wing nut, Stainless steel DIN 314/315



J53
Spur gear coaxial gearbox, from 0.43 to 1.15 - In-line



PSG2
Spur gear - precision range, Pre-hardened Steel 35NCD6



TTQ
Hexagonal locking assembly, Low torque



RHTtcss
High Temperature Castors, up to 200kg



HRV
V-rail guidance system, Rail with carriage

Complementary products



BOXINS300
Self tapping insert, Boxed set - For hard materials



CHC
Socket headed screw CHC - DIN 912, Steel class 12.19



INSTool
Self tapping insert, Insertion tool