

- Bar stock to be cut to length by the customer
- The overall length is the same as the maximum length
- Material : Steel C40

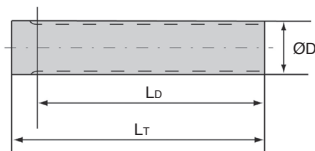

### Info.

- We are unable to modify this product

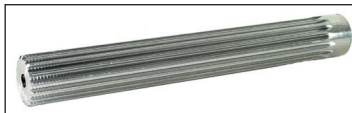

### DISCOUNTS

|       |           |            |    |
|-------|-----------|------------|----|
| Qty   | 1+        | 2+         | 4+ |
| Disc. | List -20% | On request |    |

| Part number | Z<br>Teeth | ØD<br>External | Length of<br>teeth L <sub>b</sub> | Total length<br>L <sub>T</sub> | Price each |
|-------------|------------|----------------|-----------------------------------|--------------------------------|------------|
| 18HTD8M-BAR | 18         | 44,47          | 200                               | 200                            | 47,27 €    |
| 19HTD8M-BAR | 19         | 47,01          | 200                               | 200                            | 50,51 €    |
| 20HTD8M-BAR | 20         | 49,56          | 200                               | 200                            | 53,27 €    |
| 21HTD8M-BAR | 21         | 52,11          | 200                               | 200                            | 55,44 €    |
| 22HTD8M-BAR | 22         | 54,65          | 200                               | 200                            | 58,15 €    |
| 23HTD8M-BAR | 23         | 57,20          | 200                               | 200                            | 60,87 €    |
| 24HTD8M-BAR | 24         | 59,75          | 200                               | 200                            | 63,57 €    |
| 25HTD8M-BAR | 25         | 62,29          | 200                               | 200                            | 65,19 €    |
| 26HTD8M-BAR | 26         | 64,84          | 200                               | 200                            | 70,67 €    |
| 28HTD8M-BAR | 28         | 69,93          | 200                               | 200                            | 77,74 €    |
| 30HTD8M-BAR | 30         | 75,03          | 200                               | 200                            | 88,57 €    |
| 32HTD8M-BAR | 32         | 80,12          | 200                               | 200                            | 102,85 €   |
| 34HTD8M-BAR | 34         | 85,21          | 200                               | 200                            | 111,97 €   |
| 35HTD8M-BAR | 35         | 87,76          | 200                               | 200                            | 124,06 €   |
| 36HTD8M-BAR | 36         | 90,30          | 200                               | 200                            | 130,12 €   |
| 38HTD8M-BAR | 38         | 95,40          | 200                               | 200                            | 145,30 €   |
| 40HTD8M-BAR | 40         | 100,49         | 200                               | 200                            | 159,15 €   |
| 44HTD8M-BAR | 44         | 110,67         | 200                               | 200                            | 188,85 €   |
| 48HTD8M-BAR | 48         | 120,86         | 200                               | 200                            | 220,95 €   |

Dimensions in mm

## Our other products



CHN\_CHNSS

Straight long link chain, Galvanised steel



COA-COG

Surface mounting plate, Surface mounting plate for clevis



G2

Steel spur gear, Steel 20NCD2



BOX-CS

Hose clamp, Box set of steel hose clamps



NRR

Adjustable support clamp, Adjustable support clamp

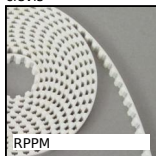

RPPM

RPP type belt per metre, RPP8 Steel cored polyurethane



NTM

Nylon tipped set screw, Nylon-point



PR881

Idler sprocket for slat top chain, Range 881



CHA\_GC\_9SS

Stainless steel garnet hinge, To be welded



SUPss

Self-centering clamping hub stainless steel, Self-centering clamping hub stainless steel,



BPLE

Ball transfer unit push fit, Light



GP

Spring loaded toggle latch, With padlock-holder

## Complementary products



HTD5M-BAR

HTD type tooth bar stock, HTD5