

Steel or aluminium

Pitch
5mm

Belt width 9mm

- For use with RPP5 belt
- Pitch: 5mm
- Material: aluminium or phosphated steel depending on size

Supplied with pilot bore



Accessories

- Belts RPP5
- Belt tension roller GTC

Info.

- **Pilot bore dimension is given as a guide only may vary between batches
- To be finished to size by customer
- **We are unable to modify these parts.**

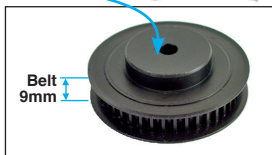
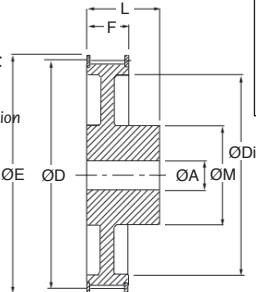

DISCOUNTS

Qty	1+	6+	20+
Disc.	List	-12%	On request

Part number	Material	No. of teeth	PCD Ø external	ØD flange	OE	OM	ØDi	F	L	Pilot bore		Price each 1 to 5
										**ØA	Stock*	
12HTD5M-09F	Steel	12	19,10	17,96	23,0	13,0	-	14,5	20,0	4	✓	5,70 €
14HTD5M-09F		14	22,28	21,14	25,0	13,0	-	14,5	20,0	6	✓	6,17 €
15HTD5M-09F		15	23,87	22,73	28,0	16,0	-	14,5	20,0	6	✓	6,45 €
16HTD5M-09F		16	25,46	24,32	28,0	16,5	-	14,5	20,0	6	✓	6,85 €
18HTD5M-09F		18	28,65	27,51	32,0	20,0	-	14,5	20,0	6	✓	7,54 €
20HTD5M-09F		20	31,83	30,69	36,0	23,0	-	14,5	22,5	6	✓	8,01 €
21HTD5M-09F		21	33,42	32,28	38,0	24,0	-	14,5	22,5	6	✓	8,31 €
22HTD5M-09F		22	35,01	33,87	39,0	25,5	-	14,5	22,5	6	✓	8,63 €
24HTD5M-09F		24	38,20	37,06	42,0	27,0	-	14,5	22,5	6	✓	9,18 €
26HTD5M-09F		26	41,38	40,24	44,0	30,0	-	14,5	22,5	6	✓	9,59 €
28HTD5M-09F		28	44,56	43,42	48,0	30,5	-	14,5	22,5	6	✓	10,00 €
30HTD5M-09F		30	47,75	46,60	51,0	35,0	-	14,5	22,5	6	✓	10,40 €
32HTD5M-09F		32	50,93	49,79	54,0	38,0	-	14,5	22,5	8	✓	11,74 €
36HTD5M-09F		36	57,30	56,16	60,0	38,0	-	14,5	22,5	8	✓	12,25 €
40HTD5M-09F	40	63,66	62,52	71,0	38,0	-	14,5	22,5	8	✓	12,69 €	
44HTD5M-09	Aluminium	44	70,03	68,89	-	38,0	54	14,5	25,5	8	-	19,49 €
48HTD5M-09		48	76,39	75,25	-	45,0	61	14,5	25,5	8	✓	21,52 €
60HTD5M-09		60	95,49	94,35	-	45,0	80	14,5	25,5	8	✓	31,51 €
72HTD5M-09		72	114,59	113,45	-	45,0	100	14,5	25,5	8	✓	44,58 €

*Depending on availability - Dimensions in mm

Our other products



PSG25
Spur gear - precision range, Pre-hardened Steel 35NCD6



SLV
Vertical toggle clamp, Vertical Lever Clamp - steel



S4
Chain sprocket - stainless steel, 4mm



PRF_ROUL_F
Castor for aluminium profile, With brake



SH0
Parallel axis helical gear, Machined plastic (delrin)



GAL_20
Conveyor roller for Ø20mm spindle, Self-lubricating polyamide



FIRSTDC1Q60
Speed controller 10A, 10 A



PR105
Articulated foot Ø103, Ø 103



BDP2R
Adjustable support arm, Increased grip



M2
Worm and wheel set, Unhardened steel

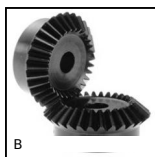

B
Steel bevel gear, 1:1

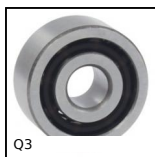

Q3
Double row angular contact ball bearing, Angular contact - Steel

Complementary products

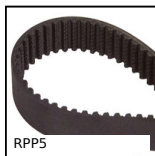

RPP5
RPP heavy duty timing belt, RPP5



GTC
Belt tensioner, For standard applications