

Hexagonal spacer

Sta Stock

HS

Stainless steel 303

- Female/female pillar
- Material:
stainless steel 303
- Sold by the packet

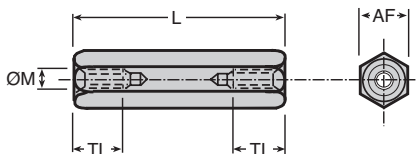

DISCOUNTS

N° packets	1+	5+	20+	100+
Discount	Prix	-20%	-30%	On request

Part number	Thread ØM	L	TL	AF	Qty per packet	Stock*	Price per packet
HS3-5/B	M3	5	5	5,5	20	✓	15,98 €
HS3-8/B	M3	8	8	5,5	20	-	16,92 €
HS3-10/B	M3	10	10	5,5	20	✓	17,25 €
HS3-15/B	M3	15	15	5,5	20	✓	21,03 €
HS3-20/B	M3	20	20	5,5	20	✓	26,19 €
HS3-25/B	M3	25	10	5,5	20	-	27,58 €
HS3-35/B	M3	35	10	5,5	20	✓	30,63 €
HS3-40/B	M3	40	10	5,5	20	-	31,39 €
HS4-5/B	M4	5	5	7,0	20	-	18,92 €
HS4-8/B	M4	8	8	7,0	20	-	20,64 €
HS4-10/B	M4	10	10	7,0	20	✓	22,59 €
HS4-12/B	M4	12	12	7,0	20	✓	24,22 €
HS4-15/B	M4	15	15	7,0	20	-	27,12 €
HS4-20/B	M4	20	20	7,0	20	✓	30,01 €
HS4-25/B	M4	25	10	7,0	20	✓	30,48 €

*Depending on availability - Dimensions in mm

HPC

WEB
04/2020

www.hpceurope.com

Tél: 0 825 88 5000 Service 0,15 €/min + prix appel

Our other products



RCC_RCX

Spherical tilt washer -
DIN6319, concave



BPFLss

Pressed stainless
steel flange bearing,
Stainless steel



PLB

Cylindrical spacer,
Brass



CHAsb63

Hinge without pin,
Polymer pin hinge



PX

Optional output shaft
stainless steel, P
gearboxes single
sided outp...



HTD5M-BAR

HTD type tooth bar
stock, HTD5



PW_PWG15

Wheel - precision
range, Bronze



M

Bellows cover,
Accessory:



PITA

Locking bolt, with T
handle



RAG-12-M8

Roller guide
accessory, Anchoring



PAMF100EB

Articulated foot with
sheet metal base



CHB

Worm and wheel gear
reducer, up to 22 Nm

Complementary products



MPS

Hexagonal spacer,
Stainless steel 303



MHX

Hexagonal threaded
sleeve, Hexagonal -
steel