

- Handwheel (only)
- Conforms to DIN950
- Versions with and without DIN6885-1 keyways
- Material:  
Stainless steel 1.4401 (316)  
Finish: turned and polished

316 stainless steel



### Accessory

- HLUMSS rotating handle

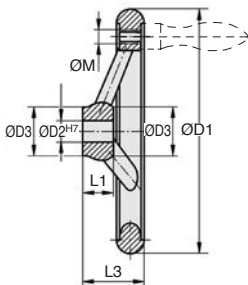
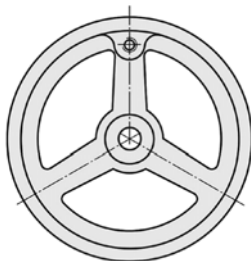
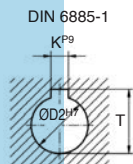

### DISCOUNTS

Qty	1+	3+	5+	10+
Disc.	List	-5%	-10%	On request

Part N°	ØD1	ØD2	ØD3	L1	L3	M	K	T	N° of spokes	Price each 1 to 2
<b>No keyway</b>										
HLU100-10/SS	100	10	26	17	33	M6	-	-	3	52,98 €
HLU125-12/SS	125	12	28	18	36	M8	-	-	3	75,98 €
HLU140-14/SS	140	14	30	19	39	M8	-	-	3	98,03 €
HLU160-16/SS	160	16	32	20	40	M10	-	-	3	112,01 €
HLU200-18/SS	200	18	38	24	45	M10	-	-	3	196,63 €
<b>With keyway</b>										
HLU100-10K/SS	100	10	26	17	33	M6	3	11,4	3	55,64 €
HLU125-12K/SS	125	12	28	18	36	M8	4	13,8	3	78,65 €
HLU140-14K/SS	140	14	30	19	39	M8	5	16,3	3	100,72 €
HLU160-16K/SS	160	16	32	20	40	M10	5	18,3	3	114,68 €
HLU200-18K/SS	200	18	38	24	45	M10	6	20,8	3	200,56 €

All dimensions in mm

## Our other products



NJM  
Multiple junction  
clamp, Multiple



PSG25S  
Spur gear - precision  
range, Stainless steel  
316



PRF\_GAL  
Roller for aluminium  
profile, Fixing kit for  
roller concentric



ZAmm  
Shaft for linear  
guides, Hardened  
ground steel



PVL  
Small lobed handle,  
Polyamide



BFDdII  
Locking pin for  
bushes, Nickel-plated  
steel



GGP  
Male wing knob,  
Technopolymer with  
brass spindle



DOMI30  
Domino 30 adjustable  
slide, Slide DOMILINE  
30



GB-RA  
Brass spur gear, Brass  
CuZn39Pb3



SHN  
Hexagonal nut  
DIN934, A2 Stainless

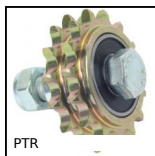

PTR  
Idle chain sprocket,  
For standard



ERC  
Quick fitting cable  
terminal, Fork

## Complementary products



VPPTss  
Stainless steel  
handwheel with  
handle, Stainless steel  
304



HLUMss  
Revolving handle for  
handwheel, Stainless  
steel 316



V3RA\_PT  
3-spoked handwheel  
with handle,  
Polyamide



V3RA  
3-spoked handwheel  
without handle,  
Polyamide