

316 stainless steel

HLUMss

- Rotating handle (only)
- Similar to DIN98
- Material:
1.4401 (316) stainless steel
Polished finish

Accessory

- See stainless steel spoked handwheel HLUSS

316 stainless steel

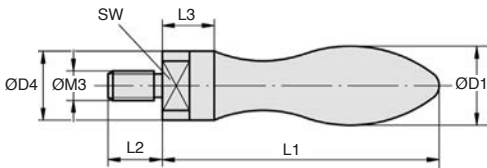

DISCOUNTS

Qty	1+	3+	5+	10+
Disc. List	-5%	-10%	On request	

Part N°	ØD1	ØM3	ØD4	L1	L2	L3	SW	Price each
								1 to 2
HLUM-M6/SS	16	M6	11	57	12	11,45	8	16,06 €
HLUM-M8/SS	21	M8	14	71	14	13,45	10	20,32 €
HLUM-M10/SS	25	M10	16	86	16	14,45	11	26,09 €

All dimensions in mm

Fax 0 825 88 6000
Service 0,15 €/min
+ prix appel

Our other products



KKP-AR

Linear bearing with inclined ball tracks, Heavy loads / -20° +200°



PTGT

Tensioner pulley, For V belts



ZG1

Plastic spur gear, Machined plastic (delrin)



NKIB

Combined bearing with inner ring, Axial load in both directions



CHMR90

Worm and wheel gear reducer, up to 540 Nm



M0

Worm and wheel set, Unhardened steel



DOMI_MD

Domino rotary table, 55/1



BAC105

Storage bin, 8mm

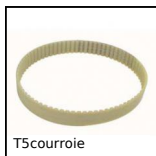

T5courroie

T type timing belt, T5 Steel cored polyurethane

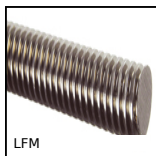

LFM

Steel leadscrew, Medium carbon steel - 1 thread



SH2

Parallel axis helical gear, Machined plastic (delrin)



RAG-12-M8

Roller guide accessory, Anchoring system

Complementary products

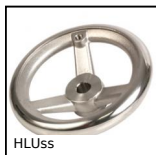

HLUss

Spoked handwheel, Stainless steel 316