

316 stainless steel

HLUMss

- Rotating handle (only)
- Similar to DIN98
- Material:
1.4401 (316) stainless steel
Polished finish

Accessory

- See stainless steel spoked handwheel **HLUSS**

316 stainless steel

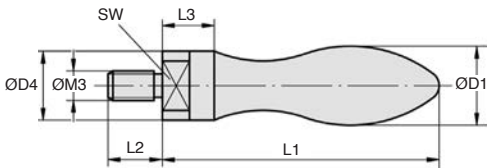

DISCOUNTS

Qty	1+	3+	5+	10+
Disc. List	-5%	-10%	On request	

Part N°	ØD1	ØM3	ØD4	L1	L2	L3	SW	Price each
								1 to 2
HLUM-M6/SS	16	M6	11	57	12	11,45	8	16,06 €
HLUM-M8/SS	21	M8	14	71	14	13,45	10	20,32 €
HLUM-M10/SS	25	M10	16	86	16	14,45	11	26,09 €

All dimensions in mm

0 825 88 6000
Service 0,15 €/min
+ prix appel

Fax

cial2@hpceurope.com

HPC

SUPPLEMENT 2019

71

Our other products



ZDB

Machined plastic
bevel gear , 2:1



PR882

Idle sprocket for slat
top chain, Range 882



MHPGR

Arm with folding
rotating handle,



CHM40-MOT

Asynchronous AC
motorgearboxes 0.18
to 0.55kW, 0.18 to
0.55kW



WW20

Drylin® W slide, slide
assembly



GMK17_RG

Joint for guiding
profile, Rounded



MDB_MTB

Moulded plastic bevel
gear (nylon), 3:1



WTM

Tightening washer -
DIN6340, Steel



GAL48_OMNI

Omni-directional
roller, Omni-



ACM_TRI

Manual bonnet
fastener, Black rubber



PPC_{ss}

Pad eye on mounting
plate squarred,



CHA35

Hinge for aluminium
profile, Hinge

Complementary products

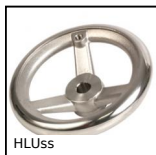

HLU_{ss}

Spoked handwheel,
Stainless steel 316