

Right angle gearbox

HLA24

Torque up to 78 Nm

- **Right angle bevel gearbox**
- Max speed 1,400 rpm
- Output backlash: 12' to 20'
- Materials:
 - Components: steel
 - Case: cast iron
- Thermal power: 6.7 kW (Heat dissipation capability)

Part number

- When ordering, specify the rotation direction and mounting position by replacing **E** and **B3** in the Part number (see presentation page)



Hollow output shaft C

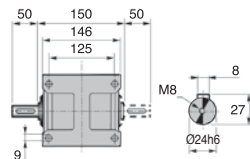
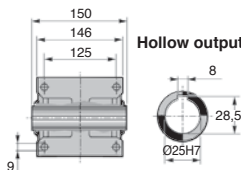

Single output shaft S or dual shafts B

With input shaft

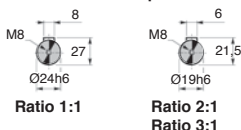

Ratio 1:1

**Ratio 2:1
Ratio 3:1**

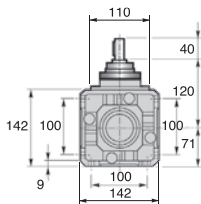

DISCOUNTS

Qty	1+	2+	4+
Disc.	List	-5%	On request

Part number	Ratio	Øinput shaft (h6)	Input shaft	Max output speed (rpm)	Mechanical output torque* (Nm)	Weight (kg)	Price each
HLA24-1-C-E-B3	1:1	24	hollow	1400	73	14	535,59 €
HLA24-2-C-E-B3	2:1	19	hollow	700	72	14	535,59 €
HLA24-3-C-E-B3	3:1	19	hollow	467	78	14	535,59 €
HLA24-1-S-E-B3	1:1	24	single	1400	73	14	501,80 €
HLA24-2-S-E-B3	2:1	19	single	700	72	14	501,80 €
HLA24-3-S-E-B3	3:1	19	single	467	78	14	501,80 €
HLA24-1-B-E-B3	1:1	24	dual	1400	73	14	533,09 €
HLA24-2-B-E-B3	2:1	19	dual	700	72	14	533,09 €
HLA24-3-B-E-B3	3:1	19	dual	467	78	14	533,09 €

*For maximum torque and a service factor applied, see presentation page - Dimensions en mm

Our other products



PGMT
Pull handle, Stainless steel



DOMI80
Connecting kits, XZ linking kit



CHNrB
Warning chain with red and white links, Steel



MSP19
Masterplate® glueable insert Ø19, Cylindrical with tapped insert



SKM
Hexagonal steel nut, Steel - 1 thread



LVT
Miniature motorised actuator 4A, 4 amperes



UGH16
H Type Guide units, For Ø12 and Ø16 actuators



ZHGS
Plastic spur gear, Machined plastic (delrin)



BLHT70
Right angled gearbox, from 26 to 128 Nm



RFK48C
Hypoid gearbox - Stainless steel, up to



DER80
Stainless steel AC asynchronous motor



HW_HT
Half-rail guide, Wheel

Complementary products



HLC24
Right angle spiro bevel gearbox, Up to 78Nm



HLA28
Right angle spiro bevel gearbox, Up to 182Nm