

# Threaded spherical knob



## GPB

## Technopolymer

- Spherical knob with moulded thread or brass insert
- Small central groove
- Material :  
Black Duroplast with brass insert

### Option

- Stainless steel or polyamide colored insert on quantities

### Info.

- Not sold individually, please contact us for details

Moulded thread

Brass insert

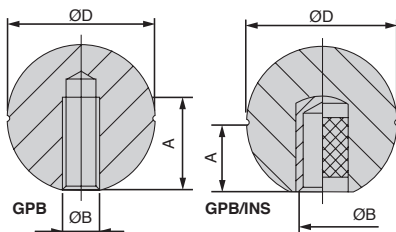
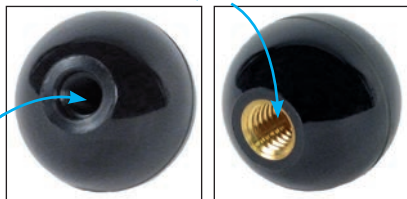

### DISCOUNTS

Qty	1+	10+	20+	50+	100+	200+
Disc.	List	-5%	-10%	-15%	-20%	On request

Part number	ØD	A	ØB	Stock*	Price each 1 to 9
<b>Moulded thread</b>					
GPB19-M4	19	10	M4	✓	1,61 €
GPB19-M5	19	10	M5	✓	1,61 €
GPB19-M6	19	10	M6	✓	1,72 €
GPB25-M6	25	17	M6	✓	1,90 €
GPB25-M8	25	17	M8	✓	1,90 €
GPB32-M8	32	20	M8	✓	2,11 €
GPB32-M10	32	20	M10	✓	2,11 €
GPB32-M12	32	20	M12	✓	2,11 €
GPB41-M10	41	20	M10	✓	2,80 €
GPB41-M12	41	20	M12	✓	2,80 €
GPB47-M14	47	23	M14	✓	3,76 €
<b>Threaded insert</b>					
GPB19-M6/INS	19	9	M6	✓	2,73 €
GPB25-M8/INS	25	15	M8	✓	2,87 €
GPB32-M8/INS	32	15	M8	✓	2,94 €
GPB32-M10/INS	32	16	M10	✓	3,27 €
GPB41-M10/INS	41	16	M10	✓	4,31 €
GPB41-M12/INS	41	18	M12	✓	5,02 €

\*Depending on availability - Dimensions in mm

## Our other products



AT5courroie

AT type timing belt,  
AT5 Steel cored  
polyurethane

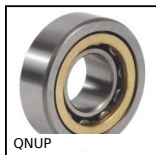

QNUP

Single row cylindrical  
roller bearing, 1 fixed  
inner flange and 1 fr...



LRRss

Latch, Spring loaded  
latch - stainless steel



BPLF

Ball transfer unit light  
duty, Light



ES

Bipod support base,  
Plastic



BOXbeta

Box of assorted hitch  
pins, Boxed set - hitch



PR40

Articulated foot Ø40,  
Ø 40

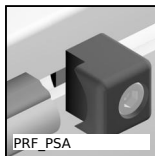

PRF\_PSA

Shaft support for  
aluminium profile,  
Shaft stop



H1

Crossed helical gear  
crossed axis at 90°,



GCA

Lynch pin, Lynch



PW\_PWG1

Wheel - precision  
range, Bronze

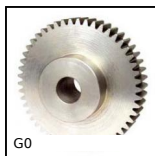

G0

Steel spur gear, Steel  
20NCD2

## Complementary products



GPB

Threaded spherical  
knob, Moulded thread



PCH

Knob for gripping,  
Mushroom



GPBSS

Threaded spherical  
knob, Stainless steel  
304



VTLF

3 lobed handle,  
Polyamide - Brass