

Curved tooth coupling, **economy range**

GFX

Torque range: 11.5 to 420 Nm

- **Rigid in torsion**
- Especially suitable for transmitting torque
- Maintenance free
- Low wearing
- 3 part construction
- Absorbs vibration
- Curved teeth
- Electrically insulating
- Materials:
 - Hub: Steel
 - Sleeve: Polyamide
- Working temp range: -20 to 80 °C



Economy range

Bores

- ⁽¹⁾Depending on the size, these are supplied either solid or with a pre-bore.
- They should be finished by the user.
- Supplied non-assembled

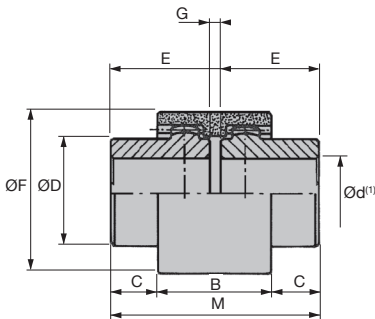

Part number	Nominal torque	Max torque	Max speed (rpm)	Weight of inertia (kg)	Moment		Misalignment	
					kg. cm ²	angular	radial (mm)	axial (mm)
GFX-14-NN	11,5	23	14000	0,166	0,27	±2°	0,7	±1
GFX-19-NN	18,5	36,5	12000	0,276	0,64	±2°	0,8	±1
GFX-24-NN	23	46	10000	0,312	0,92	±2°	0,8	±1
GFX-28-NN	51,5	103,5	8000	0,779	3,45	±2°	1	±1
GFX-32-NN	69	138	7100	0,918	5,03	±2°	1	±1
GFX-38-NN	88	176	6300	1,278	9,59	±2°	0,9	±1
GFX-42-NN	110	220	6000	1,473	13,06	±2°	0,9	±1
GFX-48-NN	154	308	5600	1,777	18,15	±2°	0,9	±1
GFX-55-NN	285	570	4800	3,380	49,44	±2°	1,2	±1
GFX-65-NN	420	840	4000	4,988	106,34	±2°	1,3	±1

Dimensions in mm

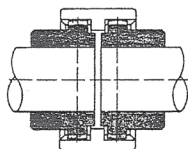

Shaft aligned

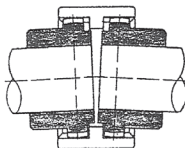

Angular misalignment

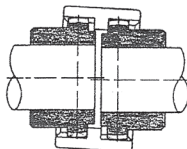

Radial misalignment

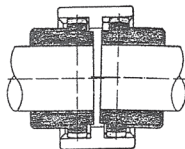

Radial and angular misalignment

DISCOUNTS

Qty	1+	5+	10+	25+
Disc.	List	-6%	-12%	On request

Part number	Bores possible Ød (h7)		B	C	ØD	E	ØF	G	M	Stock*	Price each
	Mini.	Maxi.									1 to 4
GFX-14-NN	6	14	38	6,5	25	23,5	41	4	51	✓	22,55 €
GFX-19-NN	8	19	38	8,5	32	25,5	48	4	55	✓	27,05 €
GFX-24-NN	10	24	42	7,5	36	26,5	52	4	57	✓	30,23 €
GFX-28-NN	10	28	48	19	45	41	68	4	86	✓	39,89 €
GFX-32-NN	12	32	48	18	50	40	75	4	84	✓	47,64 €
GFX-38-NN	14	38	50	17	58	40	85	4	84	✓	48,96 €
GFX-42-NN	20	42	50	19	63	42	95	4	88	✓	71,78 €
GFX-48-NN	20	48	50	27	68	50	100	4	104	✓	86,10 €
GFX-55-NN	25	55	65	29,5	82	60	120	4	124	-	137,61 €
GFX-65-NN	25	65	72	36	95	70	140	4	144	-	197,41 €

*Depending on availability - Dimensions in mm

Our other products



BLHT60
Right angled gearbox,
from 26 to 70 Nm



ACM_DZ
Clip for bonnet
fastener, Clip



FB_ECO
Eco. range steel bevel
gear, 4:1

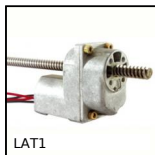

LAT1
1A motorised linear
actuator, 1 ampere



GTC
Belt tensioner, For
standard applications

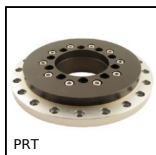

PRT
Rotary table iglidur®,
Iglidur®, aluminium
and stainless steel



EML
Stainless steel
hexagonal headed
thumb nut, Lobed
handscrew



ACLBMC
Detector support for
aluminium profile,
Sensor holder



J51
Spur gear coaxial
gearbox, from 0.13 to
0.49 Nm - In-line

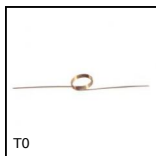

T0
Torsion spring,
Stainless steel



GMK17_P
Flat Guide, Flat guide
for conical profile



PNA_R
PERIFLEX elastic
coupling,
Replacement tyre

Complementary products



RTN
BoWex® curved tooth
gear coupling, Nylon



RTK
BoWex® curved tooth
gear coupling, Nylon
and steel