

# Jaw coupling, **economy range**



## GET-AL Torque range from 2.6 to 380 Nm

- **Rigid in torsion**
- Especially suitable for transmitting torque
- Maintenance free
- Low wearing
- 3 part construction
- Absorbs vibration
- Constant velocity
- Electrically insulating
- Materials:
  - Hub: Aluminium
  - Spider: Polyamide 94 Shore A
- Working temp range: -30 to 140 °C



**Economical range**

### Bores

- To be finished by the user

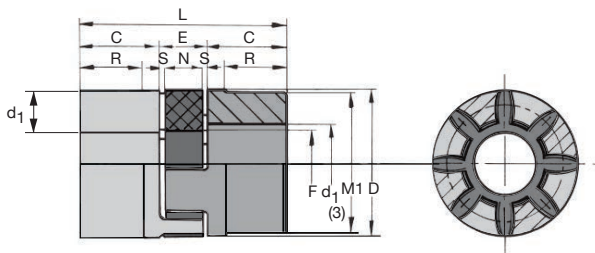

Part number	Pre-bore	Max bore		C	ØD	E	ØF	ØM1	N	R	S	L	Weight (kg)	
		d1	Spider										Hub	
GET-AL-24B	10	24	25	40	16	18	18	40	12	19	2	66	0,005	0,08
GET-AL-32B	14	32	30	55	18	27	55	14	24	2	78	0,014	0,18	
GET-AL-38B	16	38	35	65	20	30	65	15	27,5	2,5	90	0,025	0,30	
GET-AL-45B	20	45	45	80	24	38	78	18	36,5	3	114	0,042	0,55	

Dimensions in mm

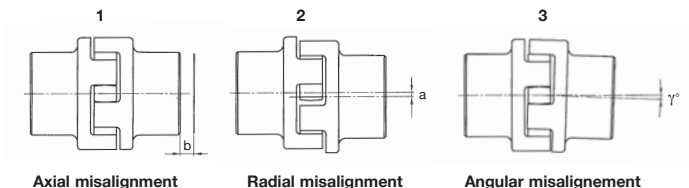

Part number	Torsional rigidity (kNm/rad)			
	1,0 Tk n	0,75 Tk n	0,5 Tk n	0,25 Tk n
GET-AL-24B	0,68	0,57	0,44	0,28
GET-AL-32B	2,19	1,82	1,40	0,90
GET-AL-38B	5,20	4,31	3,32	2,12
GET-AL-45B	10,00	8,30	6,39	4,08

## DISCOUNTS

Qty	1+	5+	10+	25+
Disc.	List -6%	List -12%	On request	On request

Part number	Moment of inertia kg.cm <sup>2</sup>	Max torque t/min	Torque (Nm)			Misalignment			Price each 1 to 4
			Nominal Tk n	Max Tk max	Alternating Tk w	axial b	radial a	angular γ°	
GET-AL-24B	0,4	14000	10	20	2,6	1,2	0,2	1,2	18,97 €
GET-AL-32B	1,0	10600	35	70	9	1,4	0,2	0,9	25,36 €
GET-AL-38B	3,0	8500	95	190	25	1,5	0,25	0,9	36,62 €
GET-AL-45B	8,0	7100	190	380	49	1,8	0,28	1,0	57,32 €

Dimensions in mm

## Our other products



Swivel castor with double brake, Polyurethane - Aluminium rim (Free



Indexing plunger, steel class 5.8



Surface mounting plate, Surface mounting plate for clevis



Cable-carrier chain for aluminium profile, Supplied in metre lengths



Moulded plastic spur gear, Moulded plastic (nylon)



Standard aluminium profile, 45 x 90 mm



Suction cup threaded insert, Insert for suction cup - Socket screw



HEAVY DUTY spur gear, Steel 35NCD6



Spur gear - precision range, Pre-hardened Steel 35NCD6



Fixed tube carrier, Fixed Ø14 to Ø20



Lock pin for clamping, Ball lock pin

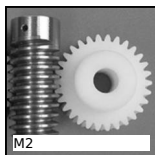

Worm and wheel set, Machined plastic (delrin)

## Complementary products



Rotex®, jaw coupling, Aluminium



PERIFLEX® elastic coupling, Complete coupling