



Spherical bushing **DIN 648**

Hard chrome/PTFE contact, with seals **GEET2RS**

- DIN 648, series E, ISO 6124/1
- Material: steel

Advantages

- No maintenance

Maintenance free

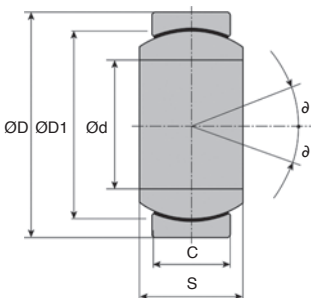

DISCOUNTS

Qty	1+	6+	20+	40+	60+	100+
Disc.	List	-10%	-15%	-20%	-30%	On request

Part number	Ød	ØD	ØD1	S	C	α	Load capacity static (N)	dynamic (N)	Weight (g)	Stock*	Price each 1 to 5
GE17ET-2RS	17 ^{+0.008}	30 ^{+0.008}	25,0	14 ^{+0.12}	10 ^{+0.24}	10°	56000	22400	30	-	10,03 €
GE20ET-2RS	20 ^{+0.010}	35 ^{+0.011}	29,0	16 ^{+0.12}	12 ^{+0.24}	9°	78000	31500	60	✓	10,29 €
GE25ET-2RS	25 ^{+0.010}	42 ^{+0.011}	35,5	20 ^{+0.12}	16 ^{+0.24}	7°	127000	51000	110	-	12,76 €
GE30ET-2RS	30 ^{+0.010}	47 ^{+0.011}	40,7	22 ^{+0.12}	18 ^{+0.24}	6°	166000	65500	140	-	13,75 €
GE35ET-2RS	35 ^{+0.012}	55 ^{+0.013}	47,0	25 ^{+0.12}	20 ^{+0.30}	6°	224000	112000	220	✓	16,20 €
GE40ET-2RS	40 ^{+0.012}	62 ^{+0.013}	53,0	28 ^{+0.12}	22 ^{+0.30}	7°	280000	140000	300	-	18,67 €
GE45ET-2RS	45 ^{+0.012}	68 ^{+0.013}	60,0	32 ^{+0.12}	25 ^{+0.30}	7°	360000	180000	400	-	22,12 €
GE50ET-2RS	50 ^{+0.012}	75 ^{+0.013}	66,0	35 ^{+0.12}	28 ^{+0.30}	6°	440000	220000	540	-	27,04 €
GE60ET-2RS	60 ^{+0.015}	90 ^{+0.015}	80,0	44 ^{+0.15}	36 ^{+0.40}	6°	695000	345000	1000	-	43,75 €
GE70ET-2RS	70 ^{+0.015}	105 ^{+0.015}	92,0	49 ^{+0.15}	40 ^{+0.40}	6°	880000	440000	1500	-	58,52 €
GE80ET-2RS	80 ^{+0.015}	120 ^{+0.015}	105,0	55 ^{+0.15}	45 ^{+0.40}	6°	1140000	570000	2200	-	86,08 €
GE90ET-2RS	90 ^{+0.020}	130 ^{+0.018}	115,0	60 ^{+0.20}	50 ^{+0.50}	5°	1370000	695000	2700	-	112,15 €
GE100ET-2RS	100 ^{+0.030}	150 ^{+0.018}	130,0	70 ^{+0.20}	55 ^{+0.50}	7°	1730000	865000	4300	-	225,32 €
GE110ET-2RS	110 ^{+0.030}	160 ^{+0.025}	140,0	70 ^{+0.20}	55 ^{+0.50}	6°	1860000	930000	4700	-	282,90 €

*Depending on availability - Dimensions in mm

Our other products



INS100
Self tapping inserts-
coarse thread, Coarse
thread



METC
Flanged sintered
bronze bush, Self-
lubricating sintered
bronze



CHTRB
Single and dual
output gearboxes, Up
to 4,7 Nm



SLBE
Indexing plunger -
Spacer, Spacer for
SLB and SLBS index
bolts



VPSS
Small 6 lobe threaded
handle - male,
Duroplast - Stainless
steel



CHAU
Screwed hinge, 270°



MET
Cylindrical sintered
bronze bush, Self-
lubricating sintered
bronze



VQTplq
Quarter-turn clamp
lock - Clamping plate,
Wall mounting

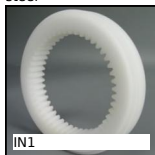

IN1
Internal gear,
Machined plastic
(delrin)



G-ECO
Eco range Spur gear,
Steel C45



CHINV2
Invisible hinge,
Invisible - Opening up
to 125°



ACLERP
Roller block for
aluminium profile,
With guide rail

Complementary products



GE_C
Spherical bushing,
Hard chromium / PTFE



GE_ES_2RS
Spherical bushing,
Steel / steel with seals