



Pipe linch pin

Zinc plated steel

GCT

- Low cost clip
- Made from white zinc plated steel
- Supplied by the packet

Advantages

- Manual assembly/disassembly

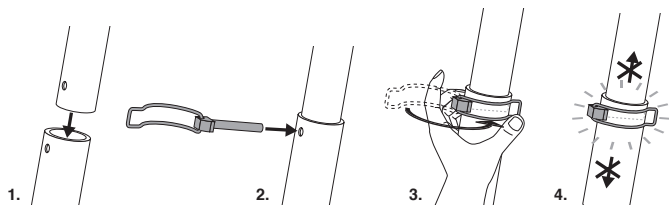
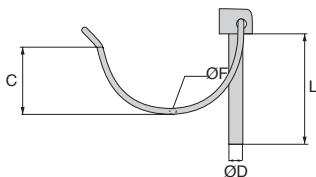

INCREASED STOCK

DISCOUNTS

Qty	1+	5+	10+	21+
Disc.	List	-10%	-20%	On request

Part number	ØD	L	C	ØF	For tube ØT	Weight per 100 (kg)	Qty per packet	Stock*	Price each 1 to 4
GCT4.5-40/B	4,5	40	18	3	38-39	1,7	50	✓	27,00 €
GCT6-32/B	6	32	18	3	30-31	2,0	50	✓	28,77 €
GCT6-45/B	6	45	22	3	43-44	2,6	50	✓	31,11 €
GCT8-40/B	8	40	18	3	38-39	3,5	50	✓	34,09 €
GCT8-45/B	8	45	22	3	43-44	3,8	50	✓	36,41 €
GCT8-50/B	8	50	25	3	48-49	4,0	50	✓	38,65 €
GCT8-60/B	8	60	28	3	58-59	4,3	50	✓	42,23 €
GCT10-40/B	10	40	18	3,2	37-38	5,0	25	✓	23,03 €
GCT10-50/B	10	50	25	3,2	47-48	5,8	25	✓	25,56 €
GCT10-60/B	10	60	28	3,2	57-58	6,3	25	✓	28,36 €

*Depending on availability - Dimensions in mm

Our other products



PLC_PLT

Magnetic stud with central hole, With central hole



DIA

Ring operated locking bolt, with ring



CLG2

Moulded plastic spur gear, Moulded plastic (nylon)



CHAsb89

Hinge without pin, Plastic hinge



BSPM

Miniature ballscrew, Nut+rolled ballscrew



DCA

Suction cup, 1.5 bellows, silicon

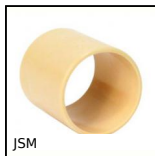

JSM

Cylindrical polymer bush, Universal polymer



GE_ES_2RS

Spherical bushing, Steel / steel with seals



PTKFss

Cap nut for foot for the food industry, Stainless steel blind



BPHT

Ball transfer unit bolt fitting, Heavy



LVT

Miniature motorised actuator 2A, 2 amperes



CHINV

Invisible hinge, Invisible - Opening up to 90°

Complementary products



GCA

Linch pin, Linch



AFA

Locking pin, with ring