

Decorative rigid latch clamp

GAE

With or without key

- **Snap closing**
- Supplied with 2 identical keys for the key versions
- Supplied with catch plate
- Material:
 - Die cast zinc black coating

NEW!



With or without key

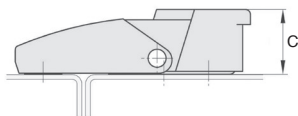
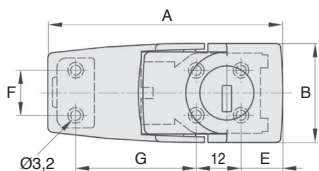

DISCOUNTS

| Qty | 1+ | 10+ | 20+ | 50+ |
|-------|------|-----|-----|------------|
| Disc. | List | -3% | -5% | On request |

| Part number | A | B | C | E | F | G | Weight (g) | Price each 1 to 9 |
|--------------------|------|------|------|------|----|------|------------|-------------------|
| Without key | | | | | | | | |
| GAE17-64 | 64,5 | 26,5 | 17,3 | 13 | 12 | 30 | 72 | |
| GAE21-76 | 76 | 32 | 21 | 16,8 | 16 | 35,5 | 118 | |
| With key | | | | | | | | |
| GAE17-64/K | 64,5 | 26,5 | 17,3 | 13 | 12 | 30 | 72 | |
| GAE21-76/K | 76 | 32 | 21 | 16,8 | 16 | 35,5 | 118 | |

Dimensions in mm

Our other products



RFVbr

Stainless steel
reaction arm,
Reaction arm



BOXINS300

Box set of self tapping
inserts, Boxed set -
For hard materials



ACLERP

Roller block for
aluminium profile,
Without guide rail



PGR

Folding revolving
handle for handwheel,
Folding



AK

Bellows coupling
Gerwah®, from 36 to
800Nm



PSPD18

Flexible tube handle,
Black PVC



SHNbr

Hexagonal nut
DIN934, Brass



CLSCLP_SS

Clevis components,
short version,
Stainless steel - short
range



DOMI80

Domino 80 adjustable
slide, Slide DOMILINE
80 with counter and



F7-SF-SM

Multifunction display,
Right angled
mounting bracket



BSM

Spring plunger with
internal hexagonal
socket, stainless steel



AT5M_AT10M

AT type timing belt
per metre, AT5 Steel
cored polyurethane

Complementary products