

# Latch clamp with lock

## GAC

## Lockable

- Snap closing
- Supplied with 2 identical keys
- Latch clamp and strike plates supplied separately
- Material:  
Galvanised steel

### Advantage

- Can be locked using a key

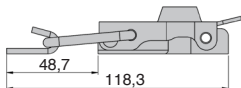
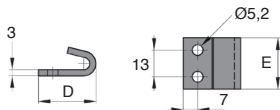
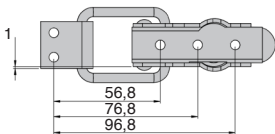
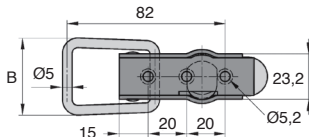
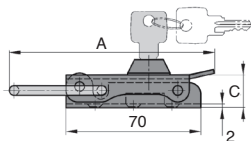
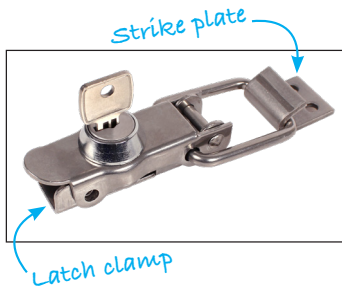

Hole layout

### DISCOUNTS

Qty	1+	10+	20+	50+	100+
Disc	List	-3%	-5%	-10%	On request

Part number	Material	Finish	A	B	C	D	E	Weight (g)	Price each
									Stock*
<b>Latch clamp</b>									
GAC-106	steel	Galvanized	106,5	40,0	17,0	-	-	132	✓ 17,94 €
<b>Strike plate</b>									
GAC-106G	steel	Galvanized	-	-	-	28	25	24	✓ 3,81 €

\*Depending on availability - Dimensions in mm

## Our other products



COA-COG

Surface mounting plate, Surface mounting plate for clevis

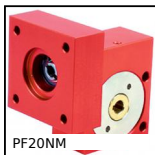

PF20NM

Worm and wheel gear reducer, up to 5 Nm



BSP

Compact precision slide, from 156 N to 980 N

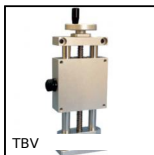

TBV

Manual lifting tables, 7kg



PR85

Articulated foot Ø83, Ø 83



LINK64

Synchronous AC Motor and- gearbox , from 1.3 to 6Nm



MEB

Moulded plastic bevel gear (nylon), 1:1



BOXKK

Boxed set of DIN6885A keys, Boxed set - Steel or stainless steel



DB

Steel bevel gear, 2:1



TBL

Mini leadscrew table with metric thread, 1kg



CABma

Swaging sleeve for fitting cable, To crimp a wire rope



HRV

V-rail guidance Simple Select® system, Rail with carriage

## Complementary products



GAC

Latch clamp with lock, Lockable