

Latch clamp with lock

GAC

Lockable

- Snap closing
- Supplied with 2 identical keys
- Latch clamp and strike plates supplied separately
- Material:
Galvanised steel

Advantage

- Can be locked using a key

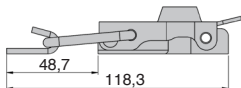
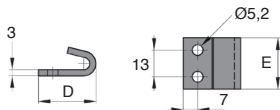
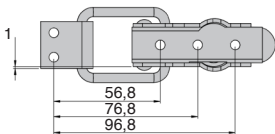
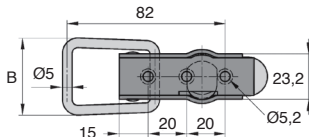
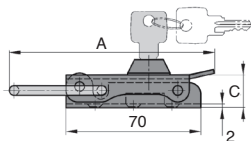
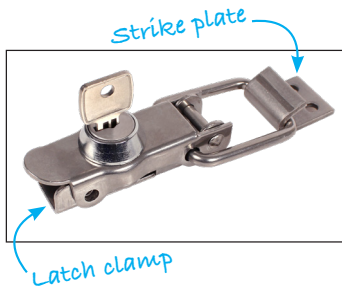

Hole layout

DISCOUNTS

Qty	1+	10+	20+	50+	100+
Disc	List	-3%	-5%	-10%	On request

Part number	Material	Finish	A	B	C	D	E	Weight (g)	Price each
									Stock*
Latch clamp									
GAC-106	steel	Galvanized	106,5	40,0	17,0	-	-	132	✓ 17,94 €
Strike plate									
GAC-106G	steel	Galvanized	-	-	-	28	25	24	✓ 3,81 €

*Depending on availability - Dimensions in mm

Our other products



BLH40

Right angled gearbox,
from 3 to 10.30 Nm



CQA20

Accessory for
adjustment slide-
system, 20



HG6-ECO

Eco range Spur gear,
Steel C45

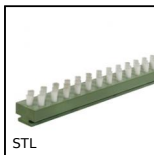

STL

Guidance brush -
Brush, Brush

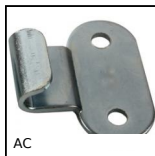

AC

Strike for toggle latch,
20mm



BC3

Panamech, Multi-
Beam stainless steel,
Stainless steel - with
clampin...



AC156-157

Strike for toggle latch,
25.5mm



PGNT

Thermoplastic T
handle, With threaded
insert



HK

Manual locking clamp,
Manual locking clamp
LWH



PCM

Fixed cylindrical
handle, Fixed non-
turning handle



UCP_PBT

Stainless/Polymer
pillow block bearing,
Polymer and stainless
steel



UGAC_UGET

Connection for
threaded actuator
rod, Connection for
threaded actuat...

Complementary products



GAC

Lock for latch clamp,
Strike plate



GE

Toggle latches,
Standard

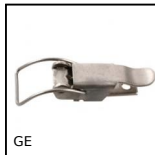

GE

Toggle latches,
Standard



SVG

Adjustable latch
clamp with strike
plate, Stroke from
82mm to 92mm