

- Magnetic strip

- The sensor contains magnetoresistive bridges which read information from the magnetic band which is transmitted to an electronic conversion circuit.
- The P25 magnetic band, which contains a 2.5mm magnetic pole, comprises of

A: A flexible magnetised plasto-ferrite band

B: A metallic strip to provide protection against dirt and any risk of mechanical friction, this is recommended and should be installed by the customer

C: A factory assembled corrosion resistant metal strip to be fixed in place on the machine or in the modular support

- Other lengths available, please ask for details

End-cap

- For an aesthetic finish

Butt jointed modular support

- Material: anodised aluminium

Magnetic ring-shaped sensor

- For measuring the angular displacement (in degrees) of a $\varnothing 14$ or $\varnothing 20$ shaft
- To be used with a multifunction display with external sensor only F7-E
- Sensor 120 steps (pitch 3°)

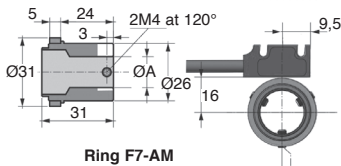

Ring F7-AM

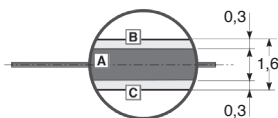
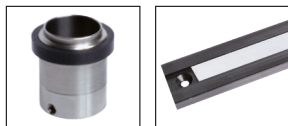

Magnetic band F7-P25/10-500

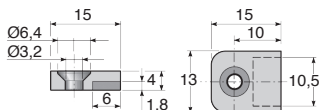

Band end-cap (2 pieces)

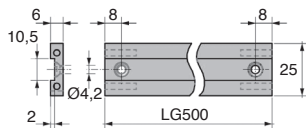

Modular support F7-SB-500

DISCOUNTS

Qty	1+	3+
Disc	List	On request

Part number	Type	Length (mm)	Shaft diameter $\varnothing A$	Price each 1 to 2
F7-P25/10-500	Magnetic band	500	-	60,29 €
F7-TB	End-cap	-	-	6,67 €
F7-SB-500	Modular support	500	-	78,16 €
F7-AM14	Magnetic ring	-	14	53,59 €
F7-AM20	Magnetic ring	-	20	53,59 €

Dimensions in mm

Our other products



G01

Single universal joint,
Normal duty

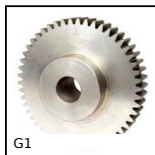

G1

Steel spur gear, Steel
20NCD2

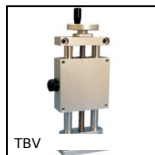

TBV

Manual lifting tables,
20kg



CLB_T

Die cast zinc clamping
lever - male, Zamak

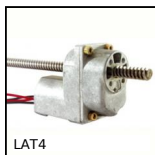

LAT4

4A motorised linear
actuator, 4 amperes



CLM

Male clevis end,
Stainless steel short



DOG258

Motor-gearbox 12V
and 24V DC, from 12
to 15 Nm



SLBWSS

Indexing plunger,
weldable, Weldable -
Stainless steel



CHMR63

Worm and wheel gear
reducer, up to 196
Nm



DCG

Suction cup, 2.5
bellows, silicon



SA_SAKH

Housing for linear
bearing, Closed - light
load



AT10courroie

AT type timing belt,
AT10 Steel cored
polyurethane

Complementary products



F7-E

Multifunction display,
With external sensor



F7-P-AM

Multifunction display,
Magnetic band