

- Magnetic strip

- The sensor contains magnetoresistive bridges which read information from the magnetic band which is transmitted to an electronic conversion circuit.
- The P25 magnetic band, which contains a 2.5mm magnetic pole, comprises of

A: A flexible magnetised plasto-ferrite band

B: A metallic strip to provide protection against dirt and any risk of mechanical friction, this is recommended and should be installed by the customer

C: A factory assembled corrosion resistant metal strip to be fixed in place on the machine or in the modular support

- Other lengths available, please ask for details

End-cap

- For an aesthetic finish

Butt jointed modular support

- Material: anodised aluminium

Magnetic ring-shaped sensor

- For measuring the angular displacement (in degrees) of a $\varnothing 14$ or $\varnothing 20$ shaft
- To be used with a multifunction display with external sensor only F7-E
- Sensor 120 steps (pitch 3°)*

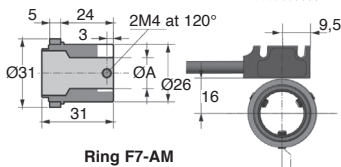

Ring F7-AM

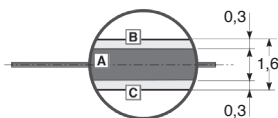
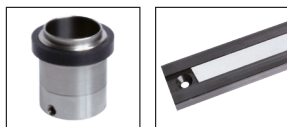

Magnetic band F7-P25/10-500

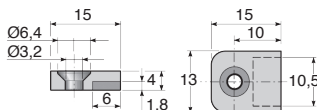

Band end-cap (2 pieces)

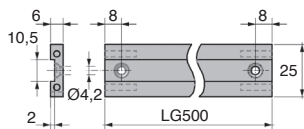

Modular support F7-SB-500

DISCOUNTS

| | | |
|------|------|------------|
| Qty | 1+ | 3+ |
| Disc | List | On request |

| Part number | Type | Length (mm) | Shaft diameter $\varnothing A$ | Price each 1 to 2 |
|---------------|-----------------|-------------|--------------------------------|-------------------|
| F7-P25/10-500 | Magnetic band | 500 | - | 60,29 € |
| F7-TB | End-cap | - | - | 6,67 € |
| F7-SB-500 | Modular support | 500 | - | 78,16 € |
| F7-AM14 | Magnetic ring | - | 14 | 53,59 € |
| F7-AM20 | Magnetic ring | - | 20 | 53,59 € |

Dimensions in mm

Our other products



PTKFss

Cap nut for foot for the food industry, Stainless steel blind nut - ...



HK

Manual locking clamp, Manual locking clamp LWL



RPP14

RPP heavy duty timing belt, RPP14



V3RA_PT

3-spoked handwheel with handle, Polyamide



BOXdhx

Boxed set of threaded dowel pins DIN979D, Boxed set - extractable D...



BPL

Ball transfer unit light duty, Light



RFK28B

Hypoid gearbox - Stainless steel, up to 130 Nm



CFF

Female rod ends DIN ISO12240-4, Steel / bronze



PRFRTR

Cross connector for aluminium profile,



GG1

Ground spur gear, Heat treated steel



RT70

Self-centering locking Assembly,



TBbutee

Axial thrust bearing, Steel balls

Complementary products



F7-E

Multifunction display, With external sensor



F7-P-AM

Multifunction display, Magnetic band