

Optional shaft for E-type gear reducers

Stainless steel

**Ex
EDX**

- Optional accessory for adding outputs shafts to E series gear reducers

Composition

- Single shaft kit E-x: shaft in stainless steel 303, 2 steelkeys and 2 steel circlips
- Double shaft kit E-dx: stainless steel 303 shaft, 3 steel keys and 2 steel circlips

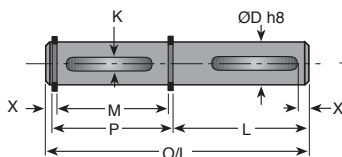

Single shaft E-X

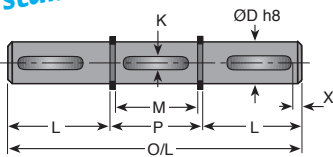

Double shaft E-DX

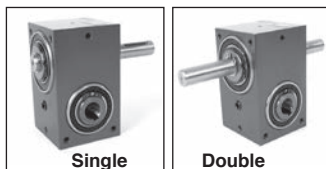

Single

Double

Assembly examples



DISCOUNTS

Qty	1+	6+	20+	40+
Disc.	List	-15%	-20%	On request

Part number	For gearbox	ØD	O/L	M	P	X	L	K	Price each 1 to 5
Single									
E20-X	E20	6	68,80	40	41,60	3,00	25	K2 x 22	47,01 €
E30-X	E30	10	98,60	54	56,20	3,50	40	K3 x 20	55,68 €
E40-X	E40	15	127,10	72	74,20	4,00	50	K5 x 30	67,62 €
E50-X	E50	20	153,80	88	90,60	4,50	60	K6 x 32	75,49 €
E60-X	E60	25	182,30	106	108,60	5,00	70	K8 x 40	81,38 €
Double									
E20-DX	E20	6	91,60	40	41,60	3,00	25	K2 x 22	60,58 €
E30-DX	E30	10	136,20	54	56,20	3,50	40	K3 x 20	69,80 €
E40-DX	E40	15	174,20	72	74,20	4,00	50	K5 x 30	81,21 €
E50-DX	E50	20	210,60	88	90,60	4,50	60	K6 x 32	94,27 €
E60-DX	E60	25	248,60	106	108,60	5,00	70	K8 x 40	110,01 €

Dimensions in mm

Our other products



CM_CO

Tools Hygienic Usit® and Hygienic Design®, Protective inserts for ...



MAX26

Motor-gearbox 12V and 24V DC, from 0,075 to 0,6Nm



TSRTC

Stem support for caster, For swivel caster with central hole



MFB_MHB

Moulded plastic bevel gear (nylon), 1.5:1



BSCm

Knurled torque knobs - male, Knurled threaded torque



MEFC

Flanged sintered ferrous bush, Self-lubricating FP20 ferrous alloy M...



MPB

Hexagonal spacer, Brass



ETQ

Magnetic label holder for aluminium profile, Label holder

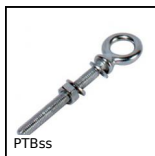

PTBss

Threaded eye hook stainless steel, Stainless steel



NRV

Orthogonal support clamp, Orthogonal support clamp



PRES

Manual workbench press accessory for PRES-3HR end PRES-4HR, Micromet...



TBEASE

Base plate for economic mini-table, Allows X-Y cross tables

Complementary products



E20

Right angle helical reducers, from 0.60 to 3.84 Nm



E30

Right angle helical reducers, from 1.50 to 9 Nm