

- Threaded plate for securing a component using a screw
- Material:
Steel sheet

Info

- Sold in packs of 1,000

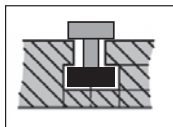

Typical application
in a T slot

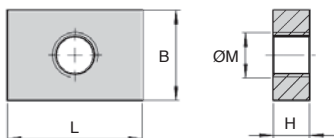
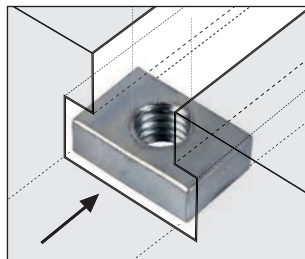

DISCOUNTS

| Qty | 1+ | 5+ | 10+ | 20+ |
|-------|------|-----|------|------------|
| Disc. | List | -5% | -10% | On request |

| Part number | L | B | H | ØM | Qty per pack | Price each 1 to 4 |
|-----------------|----|----|---|----|--------------|----------------------|
| ERT15-10-4-M5/L | 15 | 10 | 4 | M5 | 100 | 28,77 € |
| ERT15-10-4-M6/L | 15 | 10 | 4 | M6 | 100 | 28,77 € |
| ERT15-10-5-M6/L | 15 | 10 | 5 | M6 | 100 | 28,77 € |
| ERT19-16-4-M4/L | 19 | 16 | 4 | M4 | 100 | 31,95 € |
| ERT19-16-4-M5/L | 19 | 16 | 4 | M5 | 100 | 31,95 € |
| ERT19-16-4-M6/L | 19 | 16 | 4 | M6 | 100 | 31,95 € |
| ERT19-16-4-M8/L | 19 | 16 | 4 | M8 | 100 | 31,95 € |
| ERT19-19-4-M5/L | 19 | 19 | 4 | M5 | 100 | 31,95 € |
| ERT19-19-4-M6/L | 19 | 19 | 4 | M6 | 100 | 31,95 € |
| ERT19-19-4-M8/L | 19 | 19 | 4 | M8 | 100 | 31,95 € |
| ERT20-13-5-M6/L | 20 | 13 | 5 | M6 | 100 | 31,95 € |
| ERT20-13-5-M8/L | 20 | 13 | 5 | M8 | 100 | 31,95 € |
| ERT20-20-4-M4/L | 20 | 20 | 4 | M4 | 100 | 35,14 € |
| ERT20-20-6-M5/L | 20 | 20 | 6 | M5 | 100 | 35,14 € |
| ERT20-20-6-M6/L | 20 | 20 | 6 | M6 | 100 | 35,14 € |
| ERT20-20-6-M8/L | 20 | 20 | 6 | M8 | 100 | 35,14 € |
| ERT25-12-5-M6/L | 25 | 12 | 5 | M6 | 100 | 31,95 € |

Dimensions in mm

Our other products



BOXsap

Boxed set of spring pins ISO8752, Boxed set - Split ISO 8752



EBC

Cap nut Hygienic Design®, Compact



D-PAR_SS

Stainless steel progressive stop, stainless steel



BHEX

Hexagonal cap, Black technopolymer



PRF_JL2

Lip seal for panel, Door seal - Ø 2mm



RBntc

Swivel castor with central hole, Steel - rubber



SCH

Horizontal hook toggle clamp, Horizontal Hook clamp - steel



SSB

Stainless steel bevel gear, 1:1



WINGbr

Wing screw, hand tightened DIN316,



GLB

Small 6 lobe threaded handle - female,

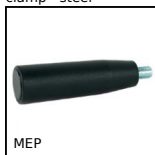

MEP

Revolving handle for handwheel, Fixed



BVR

Adjustable screw stop, Steel

Complementary products



VTH

Hexagonal headed bolts, Steel class 8.8