

Threads M3-M12

EMSH
EMS_B

- Solid knurled nut
- Material: stainless steel 18.9
- Conforms to DIN 466

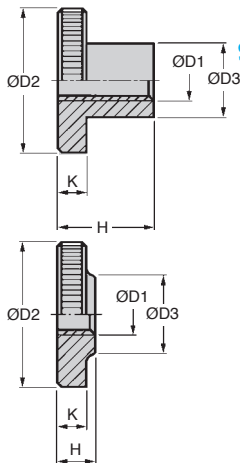

Tall version EMS-H



Low version EMS-B

DISCOUNTS

Qty	1+	6+	20+	40+	60+	101+
Disc.	List	-10%	-15%	-20%	-25%	On request

Part number	ØD1	ØD2	ØD3	H	K	Stock*	Price each 1 to 5
High version							
EMS-3H	M3	12	6	7,5	2,5	✓	1,08 €
EMS-4H	M4	16	8	9,5	3,5	✓	1,64 €
EMS-5H	M5	20	10	11,5	4,0	✓	1,91 €
EMS-6H	M6	24	12	15,0	5,0	✓	2,99 €
EMS-8H	M8	30	16	18,0	6,0	✓	6,56 €
EMS-10H	M10	36	20	23,0	8,0	✓	10,67 €
EMS-12H	M12	36	20	23,0	8,0	✓	18,05 €
Low version							
EMS-4B	M4	16	8	4,0	3,5	✓	1,26 €
EMS-5B	M5	20	10	5,0	4,0	✓	1,68 €
EMS-6B	M6	24	12	6,0	5,0	✓	2,65 €
EMS-8B	M8	30	16	8,0	6,0	✓	6,44 €
EMS-10B	M10	36	20	10,0	8,0	✓	11,59 €
EMS-12B	M12	36	20	10,0	8,0	✓	15,25 €

*Depending on availability - Dimensions in mm

Our other products



VLBG

Lifting ring, Rotating



SUPccss

Self-centering clamping hub stainless steel, With lock nut



VBFP

Small 6 lobe threaded handle - female, Duroplast - Stainless steel



GSI_A

Gas control screw for gas spring, Gas control screw



TB8

Cylindrical roller thrust bearing, Steel



PRF JL2

Lip seal for panel, Door seal - Ø 2mm



BAN

Angular clamp, Universal



PTA80

Articulated levelling foot, pressed base Ø80, Ø 80



BUT

Panel stop, Panel stop



DOMI80

Accessories, Plate



CHM50

Worm and wheel gear reducer, up to 107 Nm



J51

Spur gear coaxial gearbox, from 0.13 to 0.49 Nm - In-line

Complementary products



VMS

Stainless steel knurled thumb screw, Knurled



EMR

Fast-locking knurled nut, Knurled