

D-KONSL

Male mounting

- Silicone truncated cone form for applications with high hygiene requirements

- Materials:

304 stainless steel frame

Rubber-silicone cone cylinder (Elastosil MVQ)

- Hardness 55+/-5° shoreA

- Working temperature: -30°C to +200°C

Applications

- End stop

- Supporting foot

- Food industry (FDA compliant), pharmaceutical, medical.

NEW!

Stainless steel

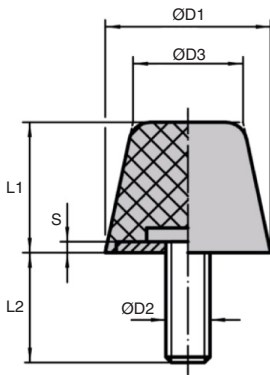

DISCOUNTS

Qty	1+	4+	15+
Disc. Price	-5%	On request	

Part number	ØD1	ØD2	L2	ØD3	L1	S	R (N/mm)	Stiffness	Max.	Weight		Price each
								load (N)	Stroke	(g)	1 to 3	
D-KON5-19-16/SL	19	M5	20	12,0	16	2	63	250	4,0	10		13,05 €
D-KON6-25-20/SL	25	M6	25	16,5	20,5	2	90	460	5,1	19		13,98 €
D-KON8-32-26/SL	32	M8	30	21,0	26	2	117	760	6,5	38		15,59 €
D-KON8-38-32/SL	38	M8	30	24,5	32	2	113	900	8,0	56		31,12 €
D-KON10-50-43/SL	50	M10	40	32,0	43	2	148	1580	10,7	110		42,57 €

Dimensions in mm



Silicone conical elast buffer

Female mounting

E-KONSL

- Silicone truncated cone form for applications with high hygiene requirements
- Materials:
 - 304 stainless steel frame
 - Rubber-silicone cone cylinder (Elastosil MVQ)
- Hardness 55+/-5° shoreA
- Working temperature: -30°C to +200°C

Applications

- End stop
- Supporting foot
- Food industry (FDA compliant), pharmaceutical, medical.

NEW!

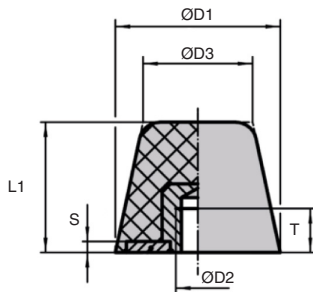

DISCOUNTS

Qty	1+	4+	15+
Disc.	Price	-5%	On request

Part number	ØD1	ØD2	L2	ØD3	L1	S	R (N/mm)	Stiffness Max. load (N)	Stroke	Weight (g)	Price each
E-KON5-19-16/SL	19	M5	12,0	16	2	5	63	250	4,0	7	13,49 €
E-KON6-25-20/SL	25	M6	16,5	20,5	2	6	90	460	5,1	14	14,82 €
E-KON8-32-26/SL	32	M8	21,0	26	2	8	117	760	6,5	20	16,77 €
E-KON8-38-32/SL	38	M8	24,5	32	2	8	113	900	8,0	46	32,30 €
E-KON10-50-43/SL	50	M10	32,0	43	2	10	148	1580	10,7	96	44,16 €

Dimensions in mm

Our other products



CABPVC

PVC covered galvanised steel cable, Galvanised steel with



SDG_SS

Universal adjustable guide support bracket, Stainless steel



VTH

Hexagonal headed bolts, Steel class 8.8



G-ECO

Eco range Spur gear, Steel C45



PSG35

Spur gear - precision range, Stainless steel 316



R206

Die spring ISO10243, Extra-heavy



RAM30

Manual bevel gearbox, Bevel



Q7

Angular contact ball bearing, Steel



AC

Strike for toggle latch, 12mm



CHT

Asynchronous AC Motor, 0.55 to 1.1kW

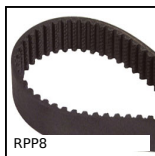

RPP8

RPP heavy duty timing belt, RPP8



ACL-APB

Closing system for aluminium profile, Magnetic door stop

Complementary products



DKONSL

Silicone conical elasto buffer, Male mounting