



## EKGS

### Servo insert coupling Torque range: 0.5 to 35 Nm

- Elastic backlash free coupling
- Reliable torque transmission
- Maintenance free
- Low inertia/size
- Easy to assembly, even in confined spaces
- Reduces vibration
- Materials:
  - Body: Aluminium
  - Spider: Polyurethane 92 Shore A (yellow)



### Applications

- Metrology, control systems, driving, machine tools, driving lead screws

#### Torque (Nm) transmissible for hub secured using set screws

Bore size	Ø3	Ø4	Ø5	Ø6	Ø7	Ø8	Ø9	Ø10	Ø11	Ø12	Ø13	Ø14	Ø15	Ø16	Ø17	Ø18	Ø20	Ø22	Ø24	Ø28
EKGS-5	0,5	0,5	0,5																	
EKGS-7	1,2	1,2	1,2	1,2	1,2	1,2														
EKGS-9	3	3	3	3	3	3	3	3	3	3										
EKGS-14	7,5	7,5	7,5	7,5	7,5	7,5	7,5	7,5	7,5	7,5	7,5	7,5	7,5							
EKGS-19				10	10	10	10	10	10	10	10	10	10	10	10	10	10	10	10	10
EKGS-24						20	22	24	26	29	31	34	35	35	35	35	35	35	35	35

Part number	Transmissible nominal torque (Nm)	Tightened torque (Nm)	Max speed (rpm)	Moment of inertia ( $10^{-6}$ kgm <sup>2</sup> )	axial (Nm)	Misalignment radial (Nm)	angular
EKGS-5	0,5	1,3	47500	0,034	-0,2/+0,4	0,06	1°
EKGS-7	1,2	1,3	34000	0,196	-0,3/+0,6	0,10	1°
EKGS-9	3	3	24000	1,08	-0,4/+0,8	0,13	1°
EKGS-14	7,5	6	16000	5,7	-0,5/+1,0	0,15	1°
EKGS-19	10	6	12000	36	-0,5/+1,2	0,10	1°
EKGS-24	35	6	8500	162	-0,5/+1,4	0,14	1°

Dimensions in mm

## Characteristics

- Hardwearing
- Fixed using set screws
- Couplings are mounted pre-tensioned
- Shaft tolerance should be g6 or h7
- Contact surfaces should be free of grease

## Bore

- Choose  $\text{ØD1}$  and  $\text{ØD2}$  from the ranges shown

## Option

- Keyway according to DIN6885-1

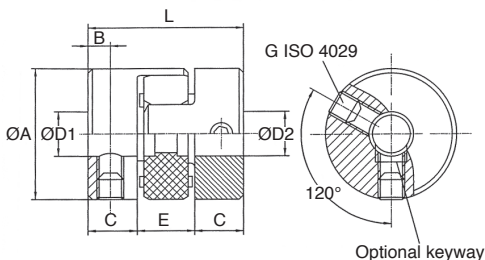

## DISCOUNTS

Qty	1+	2+	4+
Disc.	List	-6%	On request

Part number	L	ØA	E	ØD1/ ØD2		C	B	G	Weight (g)	Price each	
				No keyway	with keyway					No keyway	with keyway
EKGS-5	15	10	5	2-5	-	5	2,5	1xM3	5	33,54 €	-
EKGS-7	22	14	8	3-8	6-8	7	2,5	1xM3	9	34,75 €	34,75 €
EKGS-9	30	20	10	3-12	6-10	10	5	2xM4	17	36,11 €	36,11 €
EKGS-14	35	30	13	4-16	6-16	11	5	2xM6	41	45,40 €	45,40 €
EKGS-19	66	40	16	6-24	6-24	25	10	2xM6	138	57,43 €	57,43 €
EKGS-24	78	55	18	8-35	8-35	30	10	2xM6	282	72,07 €	72,07 €

Dimensions in mm

## Our other products



SBS\_L  
Chain link, Stainless steel



S2B  
Short linear bearing housing, Closed - Slim



PTGR  
Tensioner pulley, For round belts



SA\_SAKH  
Housing for linear bearing, Closed - light load



SCA  
Flat cable clamp, Steel



CFES  
Eccentric cam follower, Eccentric

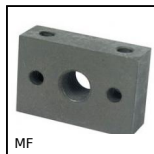

MF  
Shock Absorber - universal flange, Universal fixing



TK\_UUOP  
Topball self-aligning linear bearing, Topball self-aligning

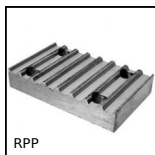

RPP  
Connecting plate for RPP type timing belts, RPP8



LRX  
Linear roller slide, Rail - from 9410 N to 101000 N



VPSS  
Small 6 lobe threaded handle - male, Duroplast - Stainless steel



MFBSC  
Stainless steel flexible bellows coupling, Stainless steel - with cl...

## Complementary products



ADSR  
Backlash free coupling Gerwah®, from 12.5 to 525 Nm



DKGS  
Backlash free coupling Gerwah®, from 0.5 to 3 Nm