

## D-PAR D-KON

### Male mounting

- Large degree of deformation accepted thus absorbing large amounts of energy
- Energy absorbed gradually
- Materials  
core: Steel plates cylinder: Rubber
- **Hardness: NK 55-60 shore A**
- Working temp: -40°C to +70°C

### Uses

- Shock-absorbing stop

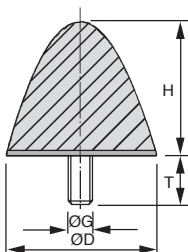

Type D-PAR

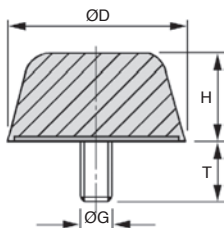

Type D-KON



### DISCOUNTS A

Qty	1+	6+	20+	40+	100+	200+
Disc.	List	-10%	-15%	-20%	-25%	On request

### DISCOUNTS B

Qty	1+	6+	10+	15+	20+	50+
Disc.	List	-10%	-15%	-20%	-25%	On request

Part number	ØG	T	ØD	H	Stock*	Price each 1 to 5
D-PAR6-20-24	M6	18	20	24	✓	A 2,64 €
D-PAR8-30-36	M8	20	30	36	✓	A 3,42 €
D-PAR8-35-40	M8	20	35	40	✓	A 5,11 €
D-PAR8-50-67	M8	36	50	67	✓	A 10,56 €
D-PAR10-50-58	M10	28	50	58	✓	A 9,30 €
D-PAR12-75-89	M12	37	75	89	✓	B 13,57 €
D-PAR16-115-136	M16	43	115	136	-	B 52,00 €
D-KON6-25-17	M6	18	25	17	-	B 2,47 €
D-KON10-50-18	M10	28	50	18	✓	A 7,00 €
D-KON12-80-30	M12	35	80	30	✓	B 17,47 €
D-KON16-125-45	M16	45	125	45	-	B 29,18 €

\*Depending on availability - Dimensions in mm

## Our other products



SUA4\_L

Chain link, Steel



PSG25

Spur gear - precision range, Stainless steel 303



BLHB30

Right angled gearbox, bored shafts, up to 4.4 Nm



PRES

Manual workbench press accessory for PRES-3HR end PRES-4HR, Tool hol...



G3

Steel spur gear, Steel 20NCD2



M2

Worm and wheel set, Hardened steel



ETP

Modular handle for aluminium profile, Modular handle



SSHBRA

Stainless steel bevel gear, 1.5:1 2:1 3:1



WS10

Drylin® W rail, Rail



KKP-AR

Linear bearing with inclined ball tracks, Heavy loads / -20°

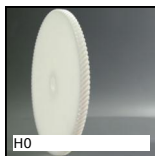

H0

Crossed helical gear crossed axis at 90°, Machined plastic



CLA

Clamping lever Hygienic Usit® - female, Stainless steel

## Complementary products



D-PAR\_SS

Stainless steel elasto mount, stainless steel



DPAR\_DKON

Progressive stop, Steel



DZY

Cylindrical stop, Steel



MC

Self-compensating shock-absorber, Self-compensating - without adjust...