

D-KONSL

Male mounting

- Silicone truncated cone form for applications with high hygiene requirements

- Materials:

304 stainless steel frame

Rubber-silicone cone cylinder (Elastosil MVQ)

- Hardness 55+/-5° shoreA

- Working temperature: -30°C to +200°C

Applications

- End stop

- Supporting foot

- Food industry (FDA compliant), pharmaceutical, medical.

NEW!

Stainless steel

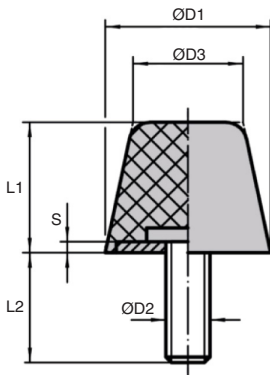
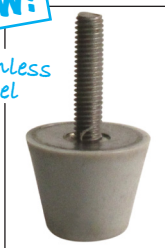

DISCOUNTS

Qty	1+	4+	15+
Disc. Price	-5%	On request	

Part number	ØD1	ØD2	L2	ØD3	L1	S	R (N/mm)	Stiffness	Max. load (N)	Stroke	Weight (g)	Price each
								2				
D-KON5-19-16/SL	19	M5	20	12,0	16	2	63	250	4,0	10		13,05 €
D-KON6-25-20/SL	25	M6	25	16,5	20,5	2	90	460	5,1	19		13,98 €
D-KON8-32-26/SL	32	M8	30	21,0	26	2	117	760	6,5	38		15,59 €
D-KON8-38-32/SL	38	M8	30	24,5	32	2	113	900	8,0	56		31,12 €
D-KON10-50-43/SL	50	M10	40	32,0	43	2	148	1580	10,7	110		42,57 €

Dimensions in mm



Silicone conical elast buffer

Female mounting

E-KONSL

- Silicone truncated cone form for applications with high hygiene requirements
- Materials:
 - 304 stainless steel frame
 - Rubber-silicone cone cylinder (Elastosil MVQ)
- Hardness 55+/-5° shoreA
- Working temperature: -30°C to +200°C

Applications

- End stop
- Supporting foot
- Food industry (FDA compliant), pharmaceutical, medical.

NEW!



Stainless steel

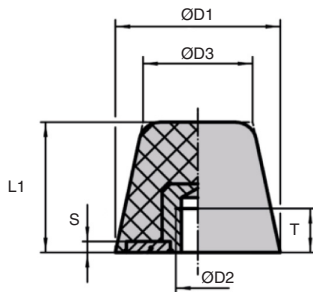

DISCOUNTS

Qty	1+	4+	15+
Disc.	Price	-5%	On request

Part number	ØD1	ØD2	L2	ØD3	L1	S	R (N/mm)	Max. load (N)	Stroke	Weight (g)	Price each
E-KON5-19-16/SL	19	M5	12,0	16	2	5	63	250	4,0	7	13,49 €
E-KON6-25-20/SL	25	M6	16,5	20,5	2	6	90	460	5,1	14	14,82 €
E-KON8-32-26/SL	32	M8	21,0	26	2	8	117	760	6,5	20	16,77 €
E-KON8-38-32/SL	38	M8	24,5	32	2	8	113	900	8,0	46	32,30 €
E-KON10-50-43/SL	50	M10	32,0	43	2	10	148	1580	10,7	96	44,16 €

Dimensions in mm

Our other products



CLAT

Clamping lever
Hygienic Usit®,
Stainless steel



HTD8M-BAR

HTD type tooth bar
stock, HTD8



M0

Worm and wheel set,
Machined plastic
(delrin)



BPHR

Ball transfer unit, High

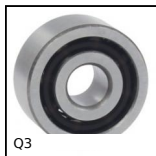

Q3

Double row angular
contact ball bearings,
Angular contact -
Steel

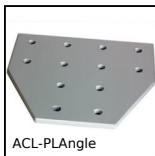

ACL-PLAngle

Connecting/joining,
Angle connection



SHA_PTR

Handwheel,
Polyamide



DOMI80

Accessories, Plate



M1

Worm and wheel set,
Non hardened steel



M1

Worm and wheel set,
Hardened steel



HTD14M_85

Heavy duty timing
pulley, HTD14 Steel



BABreglable

Adjustable locking pin
hardened steel,
adjustable

Complementary products



EKONSL

Silicone conical elasto
buffer, Female
mounting