

# Miniature bellows coupling

## DKN Couplings for servo-motors Torque: **0.4 to 10Nm**

- Backlash and maintenance free
- Materials:
  - Hub: anodised aluminium
  - Bellows: stainless steel
- Angular misalignment from 1.2° to 2° depending on the length
- High torsional rigidity
- Low moment of inertia
- Shaft/bore link without backlash
- Max speed: 15,000 rpm
- Recommended assembly tolerances H7/g6
- Working temperature -30°C to +100°C
- **Please specify bore size on order (between min and max  $\varnothing$ )**

### Options

- Keyway according to DIN6885 on request (tolerance JS9)
- Orientation of the keyways at 180° to each other
- Stainless steel version on request

### Info.

- The DK series is no longer available and has been replaced by the DKN range



clamp hub

Part number	Nominal torque (Nm)	Misalignment			Torsional stiffness $C_{\text{dyn}}$ (Nm/rad)	Moment of inertia J (g cm <sup>2</sup> )	Tightening torque (Nm)	Weight (g)
		radial ( $\Delta K$ ) (mm)	axial ( $\Delta K$ ) (mm)	Angulaire (°)				
DKN4/21	0,5	0,10	0,20	1,2	0,25	2,6	0,3	5
DKN4/24	0,5	0,15	0,30	2,0	0,19	2,6	0,3	6
DKN4/28	0,5	0,20	0,40	2,0	0,15	2,6	0,3	7
DKN9/23	1,1	0,10	0,20	1,2	0,50	2,6	0,3	6
DKN9/26	1,1	0,15	0,30	2,0	0,38	2,9	0,3	7
DKN9/30	1,1	0,20	0,40	2,0	0,30	3,2	0,3	8
DKN15/26	1,75	0,10	0,25	1,2	0,75	11,0	0,8	12
DKN15/30	1,75	0,15	0,40	2,0	0,70	12,0	0,8	14
DKN20/32	2,4	0,10	0,30	1,2	1,50	25,0	1,5	20
DKN20/38	2,4	0,20	0,40	2,0	1,30	27,0	1,5	22
DKN20/42	2,4	0,25	0,50	2,0	1,00	28,0	1,5	24
DKN45/41	5,5	0,10	0,30	1,2	6,50	98,0	3,0	58
DKN45/50	5,5	0,20	0,50	2,0	4,00	103,0	3,0	62
DKN100/47	12,0	0,15	0,40	1,2	8,10	231,0	3,0	60
DKN100/57	12,0	0,25	0,50	2,0	6,70	250,0	3,0	70

Dimensions in mm

**High Precision**

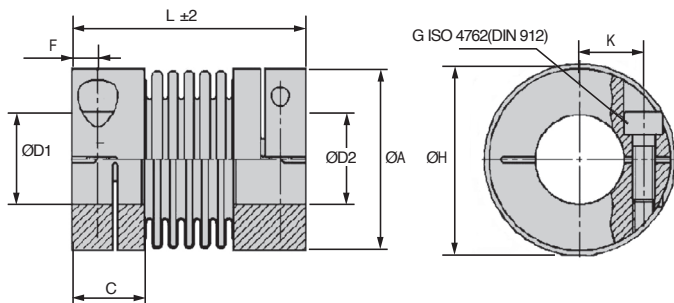

## DISCOUNTS

Qty	1+	2+	4+
Disc. List	-6%	On request	

Part number	D/D <sub>2</sub> (H7)	ØA	C	L	F	øH undercut	G (DIN 912)	K	Price each	
									No keyway	With keyway
DKN4/21	3-8	16	7	21	2	18	M2	5	63,80 €	70,16 €
DKN4/24	3-8	16	7	24	2	18	M2	5	63,80 €	70,16 €
DKN4/28	3-8	16	7	28	2	18	M2	5	63,80 €	70,16 €
DKN9/23	3-8	16	7	23	2	18	M2	5	63,80 €	70,16 €
DKN9/26	3-8	16	7	26	2	18	M2	5	70,16 €	70,16 €
DKN9/30	3-8	16	7	30	2	18	M2	5	70,16 €	70,16 €
DKN15/26	3-10	20	9	26	3	21	M2,5	7	70,16 €	70,16 €
DKN15/30	3-10	20	9	30	3	21	M2,5	7	70,16 €	70,16 €
DKN20/32	3-14	25	11	32	4	27	M3	9	74,73 €	74,73 €
DKN20/38	3-14	25	11	38	4	27	M3	9	74,73 €	74,73 €
DKN20/42	3-14	25	11	42	4	27	M3	9	74,73 €	74,73 €
DKN45/41	5-17	33	13	41	5	34	M4	12	110,45 €	110,45 €
DKN45/50	5-17	33	13	50	5	34	M4	12	110,45 €	110,45 €
DKN100/47	5-24	40	14	47	5	42	M4	16	138,27 €	138,27 €
DKN100/57	5-24	40	14	57	5	42	M4	16	138,27 €	138,27 €

Dimensions in mm

## Our other products



GARDLL

Mounting sleeve for lock pin, Nickel-plated steel or Stainless steel



PLM-C

Cylindrical holding magnets, Cylindrical holding magnet



M1

Worm and wheel set, Non hardened steel



SCH

Horizontal hook toggle clamp, Horizontal Hook clamp - steel



MSP3815

Masterplate® glueable insert rectangular, rectangular with



TCC

Rigging screw (hook/hook), Steel



LRR-53

Spring loaded latch, Spring return latch - stainless steel



ZBconique

Machined plastic bevel gear, 1:1



RT25ss

Self-centering flanged locking assembly,



CHA60

Rectangular hinge, drilled or countersunk,



KH

Linear bearing, Light



DOMI50

Connecting kits, XZ linking kit

## Complementary products



EKN

Bellows coupling Gerwah®, from 0.5 to 12Nm



MFBC

Flexible Bellows coupling, Aluminium and Bronze - with clamping jaw