

Male mounting

D-PARss D-KONss

- **Very high deformation allowing high** levels of energy to be absorbed.
- Progressive deformation
- Materials :
 - Core : Stainless steel plates (A2)
 - Head : Rubber
- **Hardness : NK 55-60 Shore A**
- Working temp: -40°C to +70°C

Uses

- Shock-absorbing stop
- D-KON12-80-30/SS
square base 80x80mm

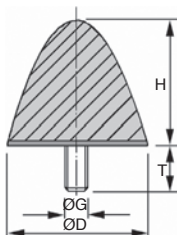

Type D-PARss

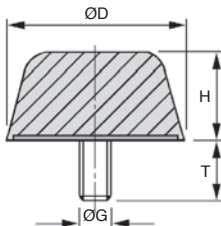

Type D-KONss

DISCOUNTS

Qty	1+	6+	20+	40+	100+
Disc.	List	-10%	-15%	-20%	On request

Part number	ØG	T	ØD	H	Stock*	Price each 1 to 5
D-PAR6-20-24/SS	M6	18	20	24	✓	3,78 €
D-PAR8-30-36/SS	M8	20	30	36	✓	5,85 €
D-PAR8-35-40/SS	M8	20	35	40	✓	15,84 €
D-PAR8-50-67/SS	M8	36	50	67	✓	16,27 €
D-PAR10-50-58/SS	M10	28	50	58	✓	12,63 €
D-KON6-25-17/SS	M6	18	25	17	✓	3,62 €
D-KON10-50-18/SS	M10	28	50	18	✓	9,09 €
D-KON12-80-30/SS	M12	35	80	30	-	48,56 €
D-KON16-125-45/SS	M16	45	125	45	-	105,56 €

*Depending on availability - Dimensions in mm

Our other products



GE1006
Elastic ringed latch,
Hooks into a slot

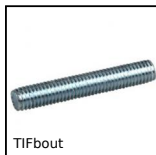

TIFbout
Threaded stud -
DIN976A, Steel



PGR
Folding revolving
handle for handwheel,
Folding



SUA4
Single chain supplied
by the metre, Steel



SA_SAKH
Housing for linear
bearing, Closed - light
load

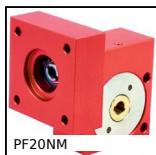

PF20NM
Worm and wheel gear
reducer, up to 5 Nm



CDGamme
Compression spring
DIN2095, DIN 2095



MET
Cylindrical sintered
bronze bush, Self-
lubricating sintered
bronze



SLBS
Stainless steel
indexing plunger,



ACLEFS
Floor anchor for
aluminium profile,



HTD8M-BAR
HTD type tooth bar
stock, HTD8



DB
Steel bevel gear, 2:1

Complementary products



DPAR_DKON
Conical elasto buffer,
Steel



D-PAR_SS
Stainless steel elasto
mount, stainless steel