

## Male mounting

## D-PARss D-KONss

- Very high deformation allowing high levels of energy to be absorbed.
- Progressive deformation
- Materials :
  - Core : Stainless steel plates (A2)
  - Head : Rubber
- **Hardness : NK 55-60 Shore A**
- Working temp: -40°C to +70°C

### Uses

- Shock-absorbing stop
- D-KON12-80-30/SS square base 80x80mm

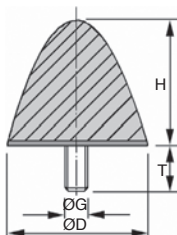

Type D-PARss

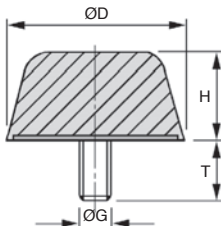

Type D-KONss

### DISCOUNTS

Qty	1+	6+	20+	40+	100+
Disc.	List	-10%	-15%	-20%	On request

Part number	ØG	T	ØD	H	Stock*	Price each 1 to 5
D-PAR6-20-24/SS	M6	18	20	24	✓	3,78 €
D-PAR8-30-36/SS	M8	20	30	36	✓	5,85 €
D-PAR8-35-40/SS	M8	20	35	40	✓	15,84 €
D-PAR8-50-67/SS	M8	36	50	67	✓	16,27 €
D-PAR10-50-58/SS	M10	28	50	58	✓	12,63 €
D-KON6-25-17/SS	M6	18	25	17	✓	3,62 €
D-KON10-50-18/SS	M10	28	50	18	✓	9,09 €
D-KON12-80-30/SS	M12	35	80	30	-	48,56 €
D-KON16-125-45/SS	M16	45	125	45	-	105,56 €

\*Depending on availability - Dimensions in mm

## Our other products



GE1006  
Elastic ringed latch,  
Hooks into a slot

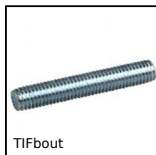

TIFbout  
Threaded stud -  
DIN976A, Steel



PGR  
Folding revolving  
handle for handwheel,  
Folding



SUA4  
Single chain supplied  
by the metre, Steel



SA\_SAKH  
Housing for linear  
bearing, Closed - light  
load

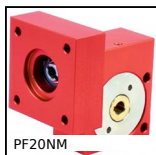

PF20NM  
Worm and wheel gear  
reducer, up to 5 Nm



CDGamme  
Compression spring  
DIN2095, DIN 2095



MET  
Cylindrical sintered  
bronze bush, Self-  
lubricating sintered  
bronze



SLBS  
Stainless steel  
indexing plunger,



ACLEFS  
Floor anchor for  
aluminium profile,



HTD8M-BAR  
HTD type tooth bar  
stock, HTD8



DB  
Steel bevel gear, 2:1

## Complementary products



DPAR\_DKON  
Conical elasto buffer,  
Steel



D-PAR\_SS  
Stainless steel elasto  
mount, stainless steel