

- Flexible ring for preventing axial movement of a shaft
- Special pliers required for mounting (not supplied)
- Material: Stainless steel A2
- Corrosion resistant
- Working temperature: -20°C to +200°C (300°C occasionally)
- Sold by the packet

stainless steel

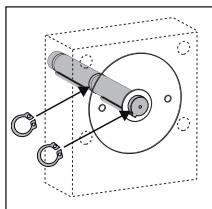

Typical application

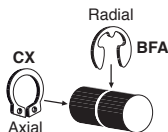
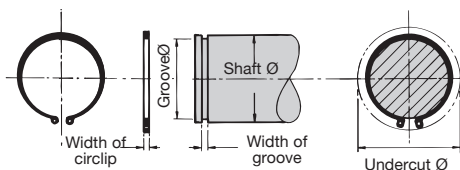

DISCOUNTS

Qty	1+	2+	4+
Disc.	List	-20%	On request

Part number	Shaft Ø	Circlip width	Groove Ø	Groove width	Undercut Ø	Qty. per packet	Stock*	Price per packet
CX-4S/B	4	0,40	3,80	0,50	8,60	200	✓	30,27 €
CX-5S/B	5	0,60	4,80	0,70	10,30	200	✓	28,59 €
CX-6S/B	6	0,70	5,70	0,80	11,70	200	✓	25,41 €
CX-7S/B	7	0,80	6,70	0,90	13,50	200	✓	34,34 €
CX-8S/B	8	0,80	7,60	0,90	14,70	200	✓	26,77 €
CX-9S/B	9	1,00	8,60	1,10	16,00	200	-	30,98 €
CX-10S/B	10	1,00	9,60	1,10	17,00	100	✓	16,88 €
CX-12S/B	12	1,00	11,50	1,10	19,00	100	✓	19,06 €
CX-14S/B	14	1,00	13,40	1,10	21,40	100	✓	25,66 €
CX-15S/B	15	1,00	14,30	1,10	22,60	100	✓	27,01 €
CX-16S/B	16	1,00	15,20	1,10	23,80	100	✓	29,05 €
CX-17S/B	17	1,00	16,20	1,10	25,00	100	✓	30,20 €
CX-18S/B	18	1,20	17,00	1,30	26,20	100	✓	42,34 €
CX-20S/B	20	1,20	19,00	1,30	28,40	100	✓	46,94 €
CX-22S/B	22	1,20	21,00	1,30	30,80	50	✓	42,69 €
CX-24S/B	24	1,20	22,90	1,30	33,20	50	✓	49,83 €
CX-25S/B	25	1,20	23,90	1,30	34,20	50	✓	47,69 €
CX-26S/B	26	1,20	24,90	1,30	35,50	50	✓	57,40 €
CX-30S/B	30	1,50	28,60	1,60	40,60	50	✓	63,61 €
CX-35S/B	35	1,50	33,00	1,60	47,00	25	✓	46,69 €

*Depending on availability - Dimensions in mm

Our other products



BFM2

Flanged bronze nut,
Bronze - 2 threads



ESCON

Speed controller 5A
accessories, Kit of 4
cables for DC motor



RPCpl

Swivel castor with
double brake, Steel -
Polyamide



ACM_DZ

Clip for bonnet
fastener, Clip



BCAss

Stainless steel splined
bush, Inox



PTA50

Articulated levelling
foot, pressed base
Ø50, Ø 50



ACLRP

Wheel for aluminium
profile, Integrated
bearing



AFA

Locking pin, with ring



EML

Stainless steel
hexagonal headed
thumb nut, Lobed



EKN

Bellows coupling
Gerwah®, from 0.5 to
12Nm



CLB_M

Die cast zinc clamping
lever - female, Zamak

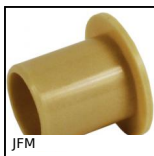

JFM

Flanged polymer
bush, Universal
polymer

Complementary products

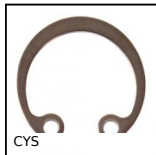

CYS

Internal circlip
DIN472, internal DIN
472



BFA

Shaft locking washer,
E clip



PAL

Self locking counter
nut, For axial locking