

Diabolo-shaped elasto mount

Ste Stock

CT-ZY

Female / female mounting

- **Radial elasticity greater than axial elasticity**
- Cylinder worked under compression or shearing
- **Materials:**
 - core: Steel plates
 - cylinder: Rubber
- **Hardness: NK 55-60 shore A**
- **Working temp: -40°C to +70°C**

Uses

- Dampens sound and vibrations



High flexibility

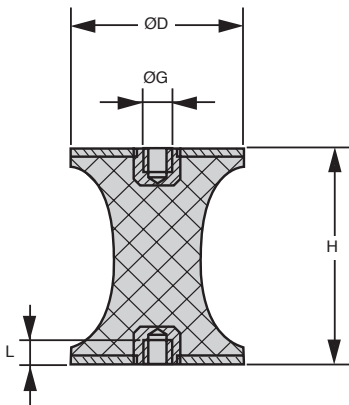

DISCOUNTS

Qty	1+	6+	20+	40+	100+	200+
Disc. List	-10%	-15%	-20%	-25%	On request	

Part number	ØG	ØD	H	L	Stock*	Price each 1 to 5
CT-ZY4-10-10	M4	10	10	4	✓	1,85 €
CT-ZY8-30-20	M8	30	20	8	✓	5,45 €
CT-ZY8-40-48	M8	40	48	8	✓	10,98 €
CT-ZY10-50-30	M10	50	30	10	-	19,25 €

*Depending on availability - Dimensions in mm

Our other products



PCS8ECO
Chain sprocket - steel,
8mm (DIN 05B-1)



SCR
Suction cup threaded
insert, Adaptor for
insert



PM3
Worm and wheel set,
Machined plastic
(delrin)



RURt
Swivel castor with
central hole,
Polyurethane -
Aluminium rim (Free



DOG316
Motor-gearbox 12V
and 24V DC, from 1.5
to 2 Nm



KBS_UU
Stainless steel closed
precision linear
bearing, Precision -
stainle...



ABL100000
Antistatic brush, For
sensitive surfaces



D19 D29
Compression springs
in metre length steel,
by the metre



RHTplss
High Temperature
Castor, up to 200kg



APB_BOU
Protective cap, Safety
cap

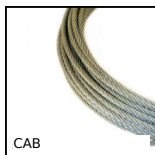

CAB
Galvanised steel
cable, Galvanised
steel



T5courroie
T type timing belt, T5
Steel cored
polyurethane

Complementary products



ATZY
Diabolo shaped elasto
mount, Steel



CTZYSS
Stainless steel diabolo
shaped elasto mount,
Stainless steel



BZY
Cylindrical elasto
mount, Steel



BZY_SS
Stainless steel
cylindrical elasto
mount, Stainless steel