

- Self aligning bearing conforming to DIN ISO 12240-1, series E (DIN648)
- Housing: Stainless steel X6CrNiMoTi17-2-2 with a PTFE coating
- Ball: Stainless steel X105CrMo17, hardened and polished
- No lubrication required
- Operating temperature : -50° to +200°C

stainless steel



Assembly

- Shaft tolerance g7
- Ball bore tolerance jS7

Advantages

- Corrosion resistant and requiring no maintenance, these bearings are suitable for heavy duty applications

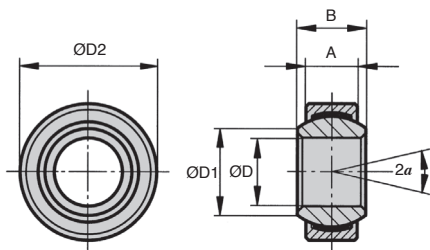

DISCOUNTS

Qty	1+	6+	10+	20+
Disc. List	-15%	-20%	On request	

Part number	Tolerance ØD (µm)	ØD1	ØD2 (h5)	A	B	Max. static load (kN)	Tilting angle a	Weight (g)	Stock*	Price each 1 to 5
CSS-06/SS	6 0/-8	8,0	14	4	6	9,0	13°	4	✓	46,05 €
CSS-08/SS	8 0/-8	10,2	16	5	8	15,6	15°	7	✓	30,65 €
CSS-10/SS	10 0/-8	13,2	19	6	9	23,4	12°	11	✓	39,96 €
CSS-12/SS	12 0/-8	14,9	22	7	10	32,0	11°	16	✓	41,96 €
CSS-15/SS	15 0/-8	18,4	26	9	12	50,0	8°	26	✓	68,25 €
CSS-16/SS	16 0/-8	20,7	30	10	14	65,0	10°	49	✓	36,96 €
CSS-17/SS	17 0/-8	20,7	30	10	14	65,0	10°	38	-	78,28 €
CSS-20/SS	20 0/-10	24,2	35	12	16	90,5	9°	61	✓	91,99 €
CSS-25/SS	25 0/-10	29,3	42	16	20	159,0	7°	110	-	108,28 €
CSS-30/SS	30 0/-10	34,2	47	18	22	197,0	6°	140	✓	133,09 €

Dimensions in mm

Our other products



ERF

Quick fitting threaded cable terminal, Cable terminal with threaded ...



MDB_MTB

Moulded plastic bevel gear (nylon), 3:1



CABma

Swaging sleeve for fitting cable, To crimp a wire rope



HSE-HSB

Hexagonal spacer, Brass



DER71

Stainless steel AC asynchronous motor 0.25 à 0.37kW, 0.25 to 0.37kW



MSP38

Masterplate® glueable insert Ø38, Cylindrical Ø38 with tapped ins...



SKM

Hexagonal steel nut, Steel - 1 thread



MHX

Hexagonal threaded sleeve, Hexagonal - stainless steel



SCH

Horizontal hook toggle clamp,



PM2

Worm and wheel set, Non hardened steel



BABtss

303 Stainless steel ball pin, 303 Stainless



AC156-157

Strike for toggle latch, 25.5mm

Complementary products



CSS

Spherical bushing, Steel / self lubricating steel



SSE

Stainless steel spherical bearing, Stainless steel / PTFE