



# Eye hook with latch **high resistance**

High strenght alloy steel

**CRLHR**

- Rigging equipment
- Material:  
High strenght alloy steel red painted

## Stamping

- ØM, CE, WLL, manufacturer

## Info

- The Breaking load is calculated by multiplying the WLL by a safety factor of 4"

High strenght

Heavy loads

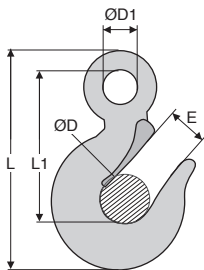

## DISCOUNTS

Qty	1+	6+	20+	30+
Disc.	List	-10%	-20%	On request

Part number	WLL (kg)	ØD1	ØD	L	L1	E	Weight (kg)	Stock*	Price each 1 to 5
CRL19-1000/HR	1000	19	26	111	79	18	0,300		
CRL22-1500/HR	1500	22	31	125,7	90	22,5	0,422		
CRL27-2000/HR	2000	27	33,5	142	102	24	0,660		
CRL31-3000/HR	3000	31	40	162,5	118,5	29	0,780		
CRL39-5000/HR	5000	39	48	200	146	32	1,650		
CRL50-7000/HR	7000	50	59	257	171	40	3,130		
CRL61-11000/HR	11000	61	68,5	315	228	48	5,370		

\*Dimensions in mm

## Our other products



Joining plate for aluminium profile, Joint plate - 45x90 mm

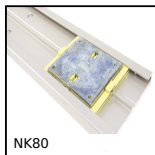

Drylin@N miniature guiding system, Width 80mm



Articulated foot Ø123, Ø 123



Articulated bracket for use with aluminium profile, Standard

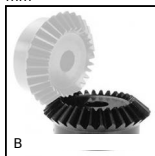

Steel bevel gear, 1:1



Right angle helical reducers, from 1.50 to 9 Nm



Right angled gearbox, bored shafts, up to 10.3 Nm

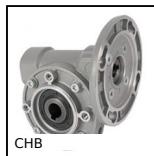

Worm and wheel gear reducer, up to 41 Nm



2 part rigid shaft clamp, Clamping jaw



H Type Guide units, For Ø12 and Ø16

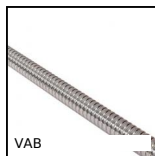

Ballscrew, supplied by the metre, Rolled



HTD type tooth bar stock, HTD8

## Complementary products