



# Asynchronous AC motor 0.09kW

Torque up to 0.64Nm

CHT56

- 3 phase AC asynchronous motor
- 4 pole motor
- Power supply 230/400V
- Speed 1500rpm
- Supply frequency 50 Hz
- Insulation class F
- Protection IP55
- Bearings: ball bearings
- Can rotate in both directions
- Rotor: Squirrel cage

New  
B14 or B5  
mounting  
flange

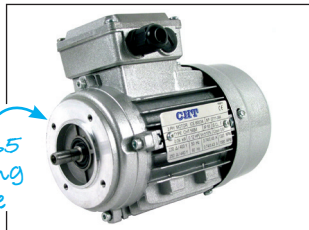

## Wiring

- See wiring diagrams N°3 and N°5 on technical information pages (tome 2 p.289)

## Accessories

- Gearbox CHM (tome 2 p.291) and gearbox CHB (tome 2 p.xxx)

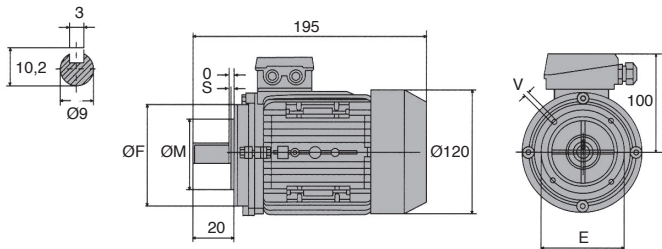

## DISCOUNTS

Qty	1+	2+	4+
Disc.	List	-10%	On request

Part number	Power (kW)	E	ØM	ØF	V	S	Current at 400V (A)	Torque (Nm)	Efficiency	Power factor cos	Weight (kg)	Stock*	Price each
<b>B14 mounting flange</b>													
CHT56B4-B14	0,09	65	50	80	M5	2,5	0,43	0,64	50%	0,61	3,2	-	101,23 €
<b>B5 mounting flange</b>													
CHT56B4-B5	0,09	100	80	120	7	3	0,43	0,64	50%	0,61	3,2	New	

\*Depending on availability - Dimensions in mm

# Asynchronous AC motor 0.12 to 0.22kW

## CHT63

## Torque up to 1.77Nm

- 3 phase AC asynchronous motor
- 4 pole motor
- Power supply 230/400V
- Speed 1500rpm
- Supply frequency 50 Hz
- Insulation class F
- Ingress protection: IP55
- Bearings: ball bearings
- Can rotate in both directions
- Rotor: Squirrel cage

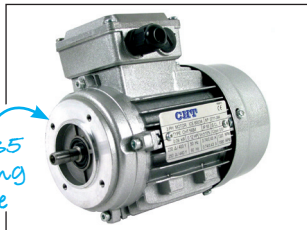

### Wiring

- See wiring diagrams N°3 and N°5 on technical information pages (tome 2 p.289)

### Accessories

- Gearbox CHM (tome 2 p.293) and gearbox CHB (tome 2 p.xxx)

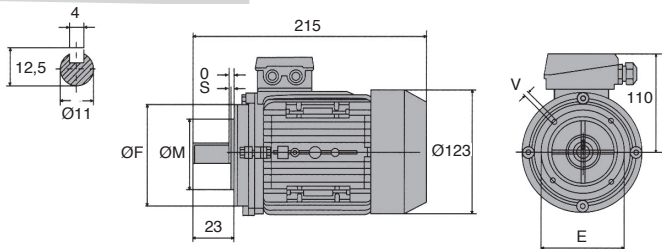

### DISCOUNTS

Qty	1+	2+	4+
Disc.	List -10%		On request

Part number	Power (kW)	E	ØM	ØF	V	S	Current at 400V (A)	Torque (Nm)	Efficiency	Power factor cos	Weight (kg)	Stock*	Price each
<b>B14 mounting flange</b>													
CHT63A4-B14	0,12	75	60	90	M5	2,5	0,47	0,85	57%	0,64	3,9	-	104,80 €
CHT63B4-B14	0,18	75	60	90	M5	2,5	0,70	1,27	57%	0,65	4,5	✓	109,88 €
CHT63C4-B14	0,22	75	60	90	M5	2,5	0,92	1,77	59%	0,67	4,8	-	115,41 €
<b>B5 mounting flange</b>													
CHT63A4-B5	0,12	115	95	140	10	3	0,47	0,85	57%	0,64	3,9	New	
CHT63B4-B5	0,18	115	95	140	10	3	0,70	1,27	57%	0,65	4,5	New	
CHT63C4-B5	0,22	115	95	140	10	3	0,92	1,77	59%	0,67	4,8	New	

\*Depending on availability - Dimensions in mm



# Asynchronous AC Motor 0.18 to 0.55kW

## Torque up to 3.81Nm

## CHT71

- 3 phase AC asynchronous motor
- 4 pole motor
- Power supply 230/400V
- Speed 1500rpm
- Supply frequency 50 Hz
- Insulation class F
- Ingress protection: IP55
- Bearings: ball bearings
- Can rotate in both directions
- Rotor: Squirrel cage

New  
B14 or B5  
mounting  
flange

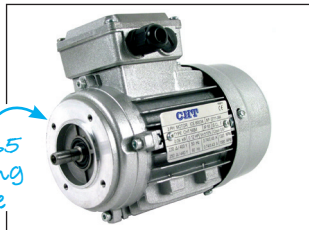

### Wiring

- See wiring diagrams N°3 and N°5 on technical information pages (tome 2 p.289)

### Accessories

- Gearbox CHM (tome 2 p.295-297) and gearbox CHB (tome 2 p.xxx)

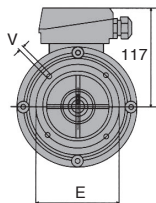
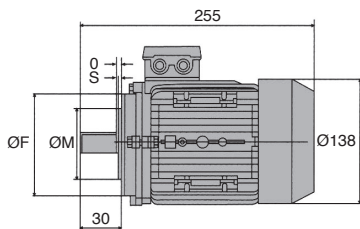
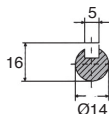

### DISCOUNTS

Qty	1+	2+	4+
Disc.	List	-10%	On request

Part number	Power (kW)	E	ØM	ØF	V	S	Current at 400V (A)	Torque (Nm)	Efficiency	Power factor cos	Weight (kg)	Stock*	Price each
<b>B14 mounting flange</b>													
CHT71A4-B14	0,25	85	70	105	M6	2,5	0,84	1,77	60%	0,62	5,6	-	118,81 €
CHT71B4-B14	0,37	85	70	105	M6	2,5	1,12	2,58	65%	0,74	6,2	✓	132,36 €
CHT71C4-B14	0,55	85	70	105	M6	2,5	1,61	3,81	66%	0,75	7,0	-	150,08 €
<b>B5 mounting flange</b>													
CHT71A4-B5	0,25	130	110	160	10	3,5	0,84	1,77	60%	0,62	5,6	New	
CHT71B4-B5	0,37	130	110	160	10	3,5	1,12	2,58	65%	0,74	6,2	New	
CHT71C4-B5	0,55	130	110	160	10	3,5	1,61	3,81	66%	0,75	7,0	New	

\*Depending on availability - Dimensions in mm

# Asynchronous AC Motor 0.55 to 1.1kW

## CHT80

## Torque up to 7.6Nm

- 3 phase AC asynchronous motor
- 4 pole motor
- Power supply 230/400V
- Speed 1500rpm
- Supply frequency 50 Hz
- B14 mounting flange
- Insulation class F
- Ingress protection: IP55
- Bearings: ball bearings
- Can rotate in both directions
- Rotor: Squirrel cage

B14  
mounting  
flange

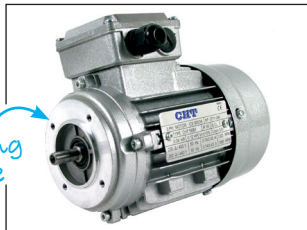

### Option

- Motor with B5 mounting flange

### Wiring

- See wiring diagrams N°3 and N°5 on technical information pages (tome 2 p.289)

### Accessories

- Gearbox CHM (tome 2 p.297, 299, 301)

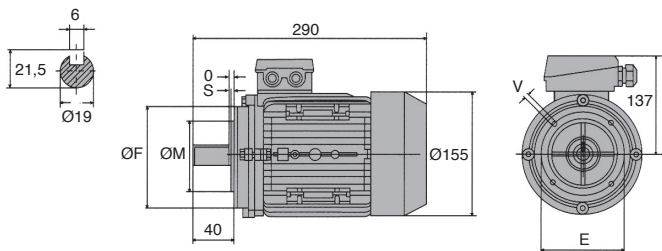

### DISCOUNTS

Qty	1+	2+	4+
Disc.	List	-10%	On request

Part number	Power (kW)	E	ØM	ØF	V	S	Current at 400V (A)	Torque (Nm)	Efficiency	Power factor cos	Weight (kg)	Stock*	Price each
CHT80A4-B14	0,55	100	80	120	M6	3	1,59	3,81	67%	0,75	8,9	-	157,24 €
CHT80B4-B14	0,75	100	80	120	M6	3	1,94	5,20	72%	0,78	10,0	✓	232,93 €
CHT80C4-B14	1,10	100	80	120	M6	3	2,64	7,58	78%	0,77	11,0	-	268,97 €

\*Depending on availability - Dimensions in mm



# Asynchronous AC Motor 1.1 to 1.85kW

Torque up to 9.24Nm

CHT90

- 3 phase AC asynchronous motor
- 4 pole motor
- Power supply 230/400V
- Speed 1500rpm
- Supply frequency 50 Hz
- B14 mounting flange
- Insulation class F
- Ingress protection: IP55
- Bearings: ball bearings
- Can rotate in both directions
- Rotor: Squirrel cage

B14 mounting flange

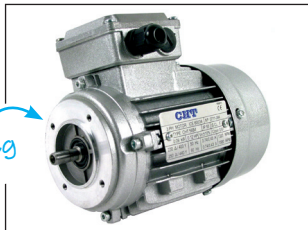

## Option

- Motor with B5 mounting flange

## Wiring

- See wiring diagrams N°3 and N°5 on technical information pages (tome 2 p.289)

## Accessories

- Gearbox CHM (tome 2 p.299-301)

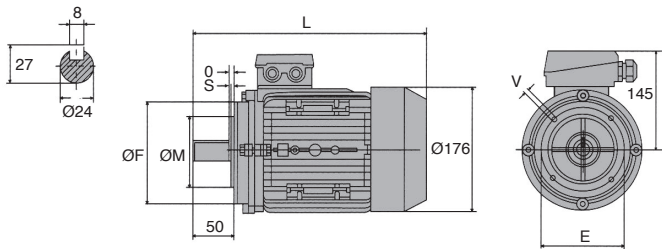

## DISCOUNTS

Qty	1+	2+	4+
Disc.	List	-10%	On request

Part number	L (mm)	Power (kW)	E	ØM	ØF	V	S	Current at 400V (A)	Torque (Nm)	Efficiency	Power factor cos	Weight (kg)	Price each
CHT90S4-B14	310	1,10	115	95	140	M8	3	2,64	5,19	76,2%	0,79	12,1	278,68 €
CHT90L4-B14	335	1,50	115	95	140	M8	3	3,46	7,51	78,5%	0,80	14,3	323,05 €
CHT90LL4-B14	335	1,85	115	95	140	M8	3	4,30	9,24	79%	0,78	16,0	323,05 €

Dimensions in mm

## Our other products



PDD  
Actuating plunger,  
Non-rotating detector  
shaft



CLM  
Male clevis end, Steel  
short



EHD06  
Internal epicyclic  
servo reducers, from  
8 to 19 Nm

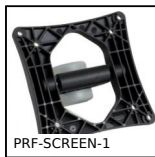

PRF-SCREEN-1  
Screen support, Basic  
support



PTA80  
Articulated levelling  
foot, pressed base  
Ø80, Ø 80



GDR880  
Straight track for slat  
top chain, Ranges 880  
and 881



DCG  
Suction cup, 2.5  
bellows, silicon



ZBconique  
Machined plastic  
bevel gear, 1:1



SUP  
Self-centering  
clamping hub steel,  
Without locknut



NTMbr  
Set screw brass tip,  
Brass-point



AC  
Strike for toggle latch,  
15mm



DOMI50  
Domino 50 adjustable  
slide, Slide DOMILINE  
50

## Complementary products



CHM30  
Worm and wheel gear  
reducer, up to 28 Nm



CHM40  
Worm and wheel gear  
reducer, up to 57 Nm



CHB  
Worm and wheel gear  
reducer, up to 41 Nm

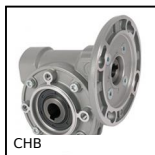

CHB  
Worm and wheel gear  
reducer, up to 41 Nm