

Worm and wheel gearbox

CHML50 Integrated torque limiter (up to 107 Nm)

- Protected against overload
- Ratios from 20:1 to 100:1
- Torque limit can be set anywhere up to the maximum value
- Materials:
 - Housing: aluminium
 - Worm: treated steel
 - Wheel: bronze (cast iron hub)
- Lubrication: synthetic oil ISO VG320

Accessory

- See CHM50

Info

- Dimensions are the same as the CHM range except for the mounting flanges which may be different



With integrated torque limiter

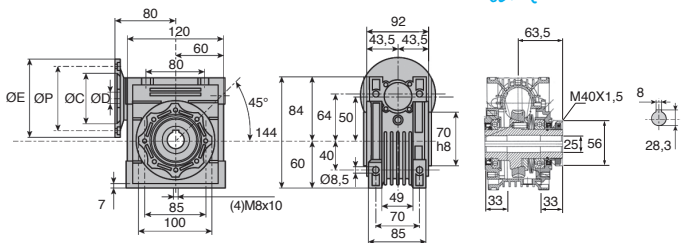

OUTPUT TORQUE (IN NM, VALUES GIVEN AS A GUIDE ONLY)

| Ratio | 20:1 | 25:1 | 30:1 | 40:1 | 50:1 | 60:1 | 100:1 |
|-------------------|------|------|------|------|------|------|-------|
| Input speed (rpm) | 2800 | 52 | 51 | 63 | 58 | 52 | 49 |
| 1400 | 72 | 69 | 83 | 75 | 72 | 67 | 54 |
| 900 | 76 | 74 | 89 | 81 | 76 | 71 | 55 |
| 500 | 92 | 90 | 107 | 97 | 90 | 82 | 64 |

DISCOUNTS

| Qty | 1+ | 3+ | 6+ |
|-------|-----------|------------|----|
| Disc. | List -20% | On request | |

| Part number | Reduction ratio | Mounting flange | ØD | ØC | ØP | ØE | Self locking | | Price each |
|-----------------|-----------------|-----------------|----|-----|-----|-----|--------------|--------|------------|
| | | | | | | | output | 1 to 2 | |
| CHML50-20-71B5 | 20:1 | 71B5 | 14 | 110 | 130 | 160 | No | | 340,14 € |
| CHML50-25-71B5 | 25:1 | 71B5 | 14 | 110 | 130 | 160 | No | | 340,14 € |
| CHML50-30-71B5 | 30:1 | 71B5 | 14 | 110 | 130 | 160 | No | | 340,14 € |
| CHML50-40-71B5 | 40:1 | 71B5 | 14 | 110 | 130 | 160 | No | | 340,14 € |
| CHML50-50-71B5 | 50:1 | 71B5 | 14 | 110 | 130 | 160 | Not defined | | 340,14 € |
| CHML50-60-71B5 | 60:1 | 71B5 | 14 | 110 | 130 | 160 | Not defined | | 340,14 € |
| CHML50-100-71B5 | 100:1 | 71B5 | 14 | 110 | 130 | 160 | Yes | | 340,14 € |

Dimensions in mm

Our other products



DP
Dowel pin, Solid ISO
2338



EPE
Wing nuts Hygienic
Design®, Narrow



MDR_SS
Stainless steel Dee
shackle with eye bolt,
Stainless steel



OP6
Mechanical digital
position indicator, 5
numbers



RHTplss
High Temperature
Castor, up to 200kg



EBH
Cap nut Hygienic
Design®, With collar



CFS
Miniature cam
follower, Miniature



BOXINS300
Box set of self tapping
inserts, Boxed set -
For hard materials



HW_HT
Half-rail guide, Wheel



GE
Toggle latches,
Miniature



CLG2
Moulded plastic spur
gear, Moulded plastic
(nylon)



PRF_ART
Articulated bracket for
use with aluminium
profile, With clamping
ha...

Complementary products



CHMBR
Reaction arm, CHM
and CHMR gear
reducers reaction arm



CHMX_CHMDX
Shaft for worm and
wheel reducer CHMR
and CHM, CHMR and
CHM gearbox...