

# Spring hinges

CHAR

Information

**The way a spring hinge opens depends on the type of spring**

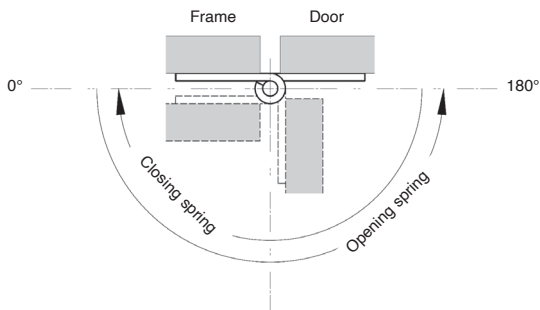

**Spring hinge torque depends on the angle**

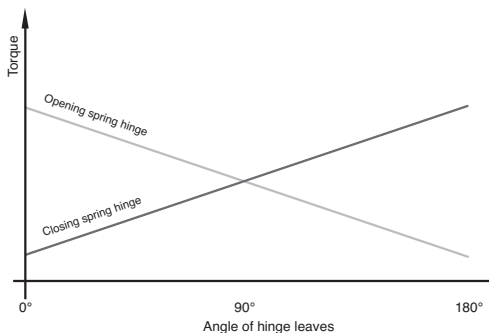

*M*: hinge torque at various positions

$M(0^\circ)$ : torque when hinge leaves are parallel

$M(90^\circ)$ : torque when leaves are at  $90^\circ$

$M(180^\circ)$ : torque when leaves are at  $180^\circ$

### Spring hinges are delivered as shown

When delivered, hinges will be in the following position:

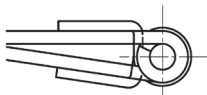

Closing spring hinge

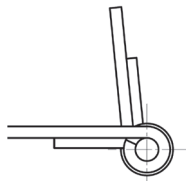

Opening spring hinge

### Mounting and opening direction

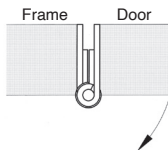

Opening spring hinge

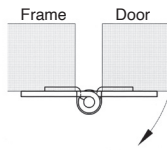

Closing spring hinge

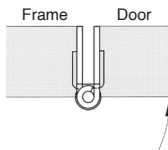

Closing spring hinge

Concealed mounting

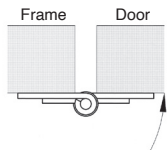

Opening spring hinge

Surface mounting

The arrow indicates the direction of rotation of the hinge due to the effect of the spring

- Hinge with opening spring
- Sheet metal with rolled knot
- Materials:
  - CHAR hinges:** steel, stainless steel spring
  - CHAR/SS hinges:** stainless steel 304, stainless steel spring
- Finish: natural
- Spring torque
  - M(0°): 0.12 Nm
  - M(90°): 0.095 Nm
  - M(180°): 0.07 Nm

Available  
in steel or  
stainless  
steel

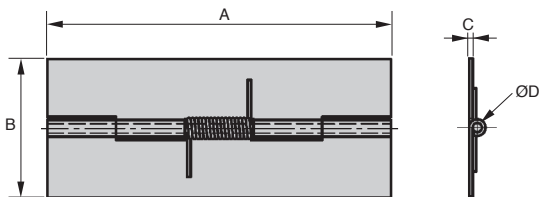

### DISCOUNTS

Qty	1+	6+	20+	50+
Disc.	List	-5%	-10%	On request

Part number	A	B	C	ØD	Spring	Weight (g)	Stock*	Price each 1 to 5
<b>Steel</b>								
CHAR7530	75	30	0,8	2	Opening	17	-	12,95 €
<b>Stainless steel</b>								
CHAR7530/SS	75	30	0,8	2	Opening	17	✓	23,13 €

\*Depending on availability - Dimensions in mm

- Hinge with opening or closing spring
- Sheet metal with rolled knot
- Materials:
  - Hinges: steel
  - Spring: stainless steel 304
  - Finish: natural
- Opening spring torque:
  - $M(0^\circ)$ : 0.09 Nm
  - $M(90^\circ)$ : 0.07 Nm
  - $M(180^\circ)$ : 0.045 Nm
- Closing spring torque:
  - $M(0^\circ)$ : 0.045 Nm
  - $M(90^\circ)$ : 0.07 Nm
  - $M(180^\circ)$ : 0.09 Nm

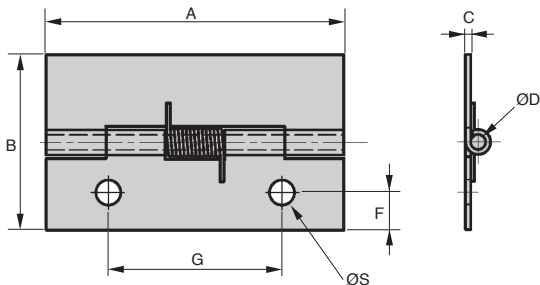

## DISCOUNTS

Qty	1+	6+	20+	50+
Disc.	List	-5%	-10%	On request

Part number	A	B	C	ØD	F	G	ØS	Spring	Weight (g)	Stock*	Price each 1 to 5
CHAR6035	60	35	1	3	7,5	35	5	Opening	22	✓	17,54 €
CHAR6035-F	60	35	1	3	7,5	35	5	Closing	22	-	13,07 €

\*Depending on availability - Dimensions in mm

## CHAR

## Automatic return

**- Hinge with opening spring**

- Sheet metal with rolled knot

- Materials:

**CHAR hinges:** steel, spring :stainless steel

**CHAR/SS hinges:** stainless steel 304: spring stainless steel

- Finish: natural

- Spring torque

M(0°): 0.12 Nm

M(90°): 0.09 Nm

M(180°): 0.06 Nm

Available  
in steel or  
stainless  
steel

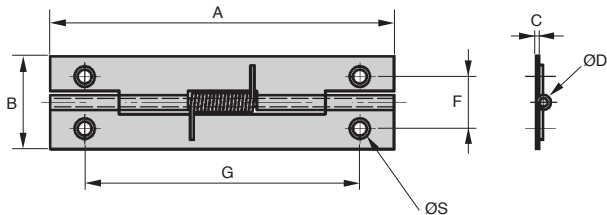

### DISCOUNTS

Qty	1+	6+	20+	50+
Disc.	List	-5%	-10%	On request

Part number	A	B	C	ØD	F	G	ØS	Spring	Weight (g)	Price each	
										Stock*	1 to 5
<b>Steel</b>											
CHAR7520	75	20	0,8	1,8	11,2	60	2	Opening	11,5	✓	9,26 €
<b>Stainless steel</b>											
CHAR7520/SS	75	20	0,8	1,8	11,2	60	2	Opening	11,5	✓	12,83 €

\*Depending on availability - Dimensions in mm

- Hinge with opening or closing spring
- Sheet metal with rolled knot
- Materials:
  - CHAR hinges:** steel, spring :stainless steel
  - CHAR/SS:** Hinges: stainless steel 304 , spring : stainless steel
- Finish: natural
- Opening spring torque:
  - M(0°) : 0.9 Nm
  - M(90°) : 0.86 Nm
  - M(180°) : 0.6 Nm
- Closing spring torque:
  - M(0°) : 0.6 Nm
  - M(90°) : 0.86 Nm
  - M(180°) : 0.9 Nm

Available  
in steel or  
stainless  
steel

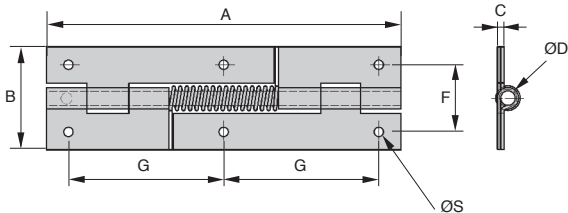

### DISCOUNTS

Qty	1+	6+	20+	50+
Disc. List	-5%	-10%	On request	

Part number	A	B	C	ØD	F	G	ØS	Spring	Weight (g)	Price each
<b>Steel</b>										
CHAR16046	160	46	3	6,5	30	70	4,2	Opening	208	27,66 €
CHAR16046-F	160	46	3	6,5	30	70	4,2	Closing	208	27,66 €
<b>Stainless steel</b>										
CHAR16046/SS	160	46	3	6,5	30	70	4,2	Opening	208	32,60 €

\*Depending on availability - Dimensions in mm

## CHAR

## Automatic return

- Hinge with opening or closing spring
- Sheet metal with rolled knot
- Materials:
  - CHAR hinge:** plated steel, spring :stainless steel
  - CHAR/SS hinge:** natural stainless steel 304: spring stainless steel
- Opening spring torque
  - M(0°): 1.5 Nm
  - M(90°): 1.1 Nm
  - M(180°): 0.65 Nm
- Closing spring torque
  - M(0°): 0.65 Nm
  - M(90°): 1.1 Nm
  - M(180°): 1.5 Nm

Available  
in steel or  
stainless  
steel

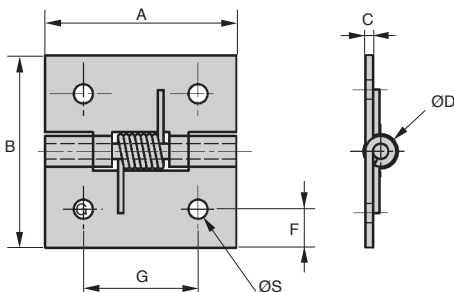

### DISCOUNTS

Qty	1+	6+	20+	50+
Disc.	List	-5%	-10%	On request

Part number	A	B	C	ØD	F	G	ØS	Spring	Weight (g)	Price each
<b>Steel</b>										
CHAR5050/Z	50	50	2	4	9	30	5	Opening	50	✓ 10,31 €
CHAR5050-F/Z	50	50	2	4	9	30	5	Closing	50	✓ 10,79 €
<b>Stainless steel</b>										
CHAR5050/SS	50	50	2	4	10	30	5	Opening	50	✓ 16,11 €
CHAR5050-F/SS	50	50	2	4	10	30	5	Closing	50	✓ 18,53 €

\*Depending on availability - Dimensions in mm

- **Hinge with concealed mechanism**
- Automatic opening or closing of a door or panel
- Resists humidity
- Elegant design
- Low play
- Max opening angle 180°
- Working temp range: -20° to 80 °C
- Fixed using DIN912 screws (not supplied)
- Materials:

Black or natural finish aluminium

Centre: PA6.6 polyamide

Washer: POM

Spring: steel

- 0.35 Nm version is guaranteed for 30,000 operations
- 1.30 Nm version is guaranteed for 10,000 operations

### Applications

- Opening doors or covers
- Industrial machines
- Metallic furniture
- Medical equipment

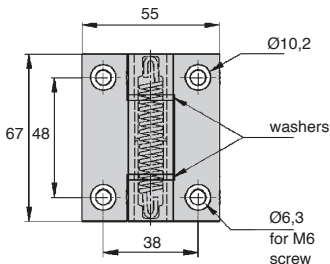

Available in black

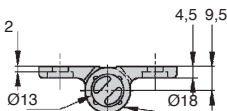

### DISCOUNTS

Qty	1+	6+	20+	50+
Disc.	List	-5%	-10%	On request

Part number	Torque (Nm)			Spring	Colour	Weight (g)	Stock*	Price each 1 to 5
	at 0°	at 90°	at 180°					
CHAR6755-L-AG	0,35	0,24	0,12	opening	natural	110	✓	28,75 €
CHAR6755-L-AN	0,35	0,24	0,12	opening	black	110	✓	28,75 €
CHAR6755-H-AG	1,3	1,1	0,9	opening	natural	110	✓	31,25 €
CHAR6755-H-AN	1,3	1,1	0,9	opening	black	110	-	31,25 €
CHAR6755-H-AG-F	1,3	1,1	0,9	closing	natural	110	✓	36,62 €
CHAR6755-H-AN-F	1,3	1,1	0,9	closing	black	110	-	36,62 €

\*Depending on availability - Dimensions in mm



# Stainless steel compact spring hinge

## CHARCAV

## Very easy to install

- Spring-loaded hinges with stopper to lock the hinges in the open position for easy assembly

- 270° opening angle

- Material

304 stainless steel, stainless steel spring

- Spring torque

Opening spring:

M(0°): 1.6 Nm

M(90°): 1.2 Nm

M(180°): 0.84 Nm

Closing spring:

M(0°): 0.75 Nm

M(90°): 1.2 Nm

M(180°): 1.65 Nm

### Info

- Spring hinge opens or closes delivered flat

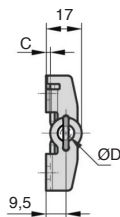
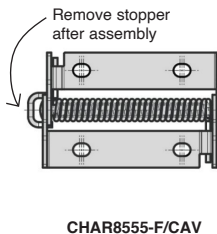
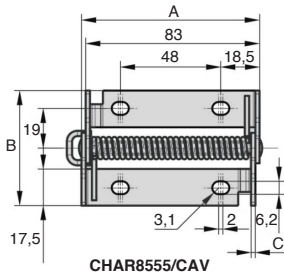
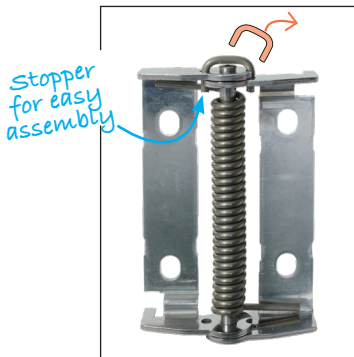

### DISCOUNTS

Qty	1+	6+	20+	50+
Disc.	List	-5%	-10%	On request

Part number	A	B	C	ØD	Type	Weight (g)	Stock*	Price each 1 to 5
CHAR8555/CAV	85	55	2	5	opening	107	-	23,33 €
CHAR8555-F/CAV	85	55	2	5	closing	107	-	23,33 €

\*Depending on availability - Dimensions in mm

## Our other products



Chain sprocket -  
Stainless steel, 9.525  
(DIN 06B-1)



Stainless steel diabolo  
shaped elasto mount,  
Stainless steel



F7-P-AM  
Multifunction display,  
Magnetic ring



DGSI  
Female rod ends,  
Steel / steel -  
Economy range

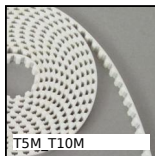

T5M T10M  
T type timing belt per  
metre, T5 Steel cored  
polyurethane



LPCM  
Lever with cylindrical  
handle, Black  
Duroplast, steel lever

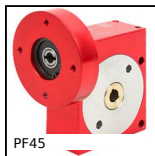

PF45  
Worm and wheel gear  
reducer, up to 40 Nm



SRG  
Adjustable latch  
clamp with strike  
plate, Stroke from  
78mm to 90mm



PTAF100-PAMF100  
Articulated fixable  
foot with pressed



ACL  
Joints for aluminium  
profile, Variable angle

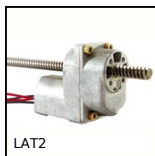

LAT2  
2A motorised linear  
actuator, 2 amperes



WJUM10  
Drylin® W bearing  
block, Slide

## Complementary products



CHAR16046  
Spring hinge, screwed



CHAR7520  
Spring hinge, screwed



CHARcav  
Spring hinge, to install