

Weld-on hinge with flat end

New

CHAPAM

In steel

- Weld-on hinge
- Flat ends
- Materials:
 - Steel
 - Brass washer

Advantage

- Easy demounting of the door or the leaf

Uses

- Metal doors
- Armoured doors
- Machine tool doors
- Electrical cabinets

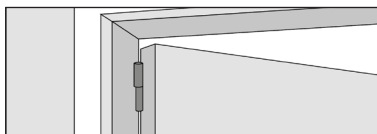

Example of use

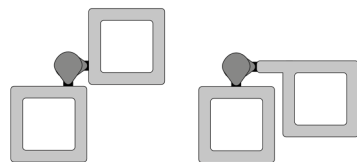

NEW!

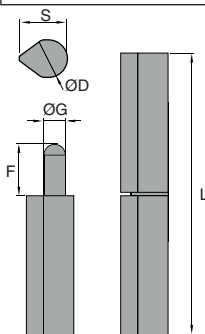

DISCOUNTS

Qty	1+	6+	20+	50+
Disc.	Price	-10%	-20%	On request

Part number	L	ØD	S	F	ØG	Price each 1 to 5
CHAPAM60-10	60	10	12,0	19,5	6	2,12 €
CHAPAM80-13	80	13	16,0	23,0	7	2,54 €
CHAPAM100-16	100	16	20,0	27,0	9	4,85 €
CHAPAM120-16	120	16	20,0	27,0	9	5,50 €
CHAPAM140-20	140	20	25,3	34,0	11	9,07 €
CHAPAM160-20	160	20	25,3	43,0	12	10,44 €
CHAPAM180-20	180	20	25,3	53,0	13	13,32 €

Dimensions in mm

New

Weld-on hinge with flat end

In stainless steel or aluminium CHAPAM

- **Weld-on hinge**
- Flat ends
- Materials:
Stainless steel 304, washer stainless steel
Aluminium, washer stainless steel

Advantage

- Easy demounting of the door or the leaf

Uses

- Metal doors
- Armoured doors
- Machine tool doors
- Electrical cabinets

NEW!

Aluminium

Stainless steel

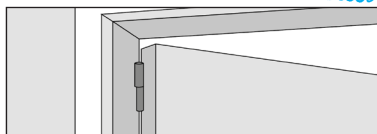

Example of use

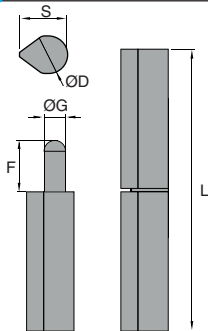
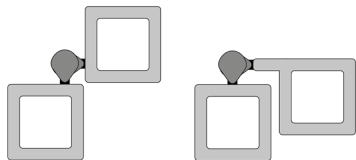
**DISCOUNTS**

Qty	1+	6+	20+	50+
Disc. Price	-10%	-20%	On request	

Part number	L	ØD	S	F	ØG	Price each 1 to 5
Stainless steel						
CHAPAM60-10/SS	60	10	12	19,5	6	12,90 €
CHAPAM80-13/SS	80	13	16	23,0	7	16,50 €
CHAPAM100-16/SS	100	16	20	27,0	9	26,25 €
Aluminium						
CHAPAM80-13/AA	80	13	16	23,0	7	11,45 €
CHAPAM100-16/AA	100	16	20	27,0	9	15,01 €
CHAPAM120-16/AA	120	16	20	27,0	9	17,39 €

Dimensions in mm

Our other products



60mm rubber wheel
for conveyor belt,
Rubber



Wheel - precision
range, Bronze



Insertion tool for self
tapping inserts,
Insertion tool



Hitch pin, Hitch



Square tube
connector, Fixed
angle



AT type tooth bar
stock, AT10

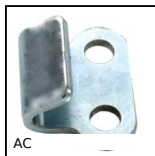

Strike for toggle latch,
18mm



Rotex®, jaw coupling,
Aluminium



24V DC motorisation
kit, Planetary gears



Worm and wheel gear
reducer, up to 298
Nm



Spur gear coaxial
gearbox, from 0.13 to
0.49 Nm - Inline



Curved tooth
coupling, economy
range, Steel and
polyamide

Complementary products



Weld-on hinge with
flat end, Steel