

# Weld-on hinge with flat end

New

## CHAPAM

In steel

- Weld-on hinge
- Flat ends
- Materials:
  - Steel
  - Brass washer

### Advantage

- Easy demounting of the door or the leaf

### Uses

- Metal doors
- Armoured doors
- Machine tool doors
- Electrical cabinets

NEW!

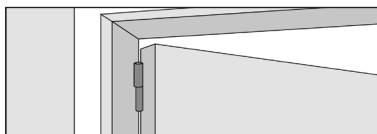

Example of use

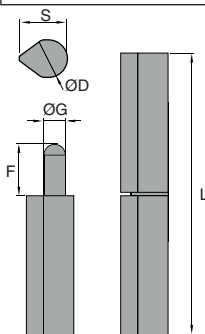
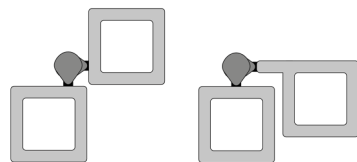

### DISCOUNTS

|       |       |      |      |            |
|-------|-------|------|------|------------|
| Qty   | 1+    | 6+   | 20+  | 50+        |
| Disc. | Price | -10% | -20% | On request |

| Part number  | L   | ØD | S    | F    | ØG | Price each<br>1 to 5 |
|--------------|-----|----|------|------|----|----------------------|
| CHAPAM60-10  | 60  | 10 | 12,0 | 19,5 | 6  | 2,12 €               |
| CHAPAM80-13  | 80  | 13 | 16,0 | 23,0 | 7  | 2,54 €               |
| CHAPAM100-16 | 100 | 16 | 20,0 | 27,0 | 9  | 4,85 €               |
| CHAPAM120-16 | 120 | 16 | 20,0 | 27,0 | 9  | 5,50 €               |
| CHAPAM140-20 | 140 | 20 | 25,3 | 34,0 | 11 | 9,07 €               |
| CHAPAM160-20 | 160 | 20 | 25,3 | 43,0 | 12 | 10,44 €              |
| CHAPAM180-20 | 180 | 20 | 25,3 | 53,0 | 13 | 13,32 €              |

Dimensions in mm

**New**

# Weld-on hinge with flat end

**In stainless steel or aluminium** **CHAPAM**

- **Weld-on hinge**
- Flat ends
- Materials:  
Stainless steel 304, washer stainless steel  
Aluminium, washer stainless steel

**Advantage**

- Easy demounting of the door or the leaf

**Uses**

- Metal doors
- Armoured doors
- Machine tool doors
- Electrical cabinets

**NEW!**

Aluminium

Stainless steel

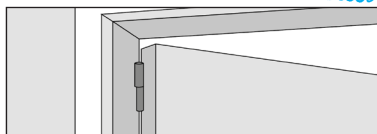

Example of use

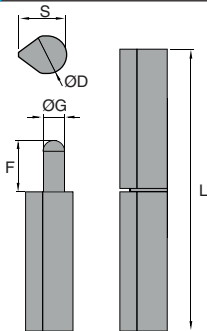
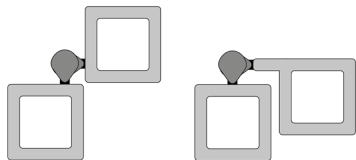
**DISCOUNTS**

|             |      |      |            |     |
|-------------|------|------|------------|-----|
| Qty         | 1+   | 6+   | 20+        | 50+ |
| Disc. Price | -10% | -20% | On request |     |

| Part number            | L   | ØD | S  | F    | ØG | Price each<br>1 to 5 |
|------------------------|-----|----|----|------|----|----------------------|
| <b>Stainless steel</b> |     |    |    |      |    |                      |
| CHAPAM60-10/SS         | 60  | 10 | 12 | 19,5 | 6  | 12,90 €              |
| CHAPAM80-13/SS         | 80  | 13 | 16 | 23,0 | 7  | 16,50 €              |
| CHAPAM100-16/SS        | 100 | 16 | 20 | 27,0 | 9  | 26,25 €              |
| <b>Aluminium</b>       |     |    |    |      |    |                      |
| CHAPAM80-13/AA         | 80  | 13 | 16 | 23,0 | 7  | 11,45 €              |
| CHAPAM100-16/AA        | 100 | 16 | 20 | 27,0 | 9  | 15,01 €              |
| CHAPAM120-16/AA        | 120 | 16 | 20 | 27,0 | 9  | 17,39 €              |

Dimensions in mm

## Our other products



GCT

Pipe lynch pin, Tube lynch pin



PTA80

Articulated levelling foot, pressed base  
Ø80, Ø 80



ZA

Shaft for linear guides, Hardened ground steel



BLOC

Doorstop, Doorstop



PSG3S

Spur gear - precision range, Stainless steel 316



OP2

Mechanical digital position indicator, 3 numbers



SBRtool

Chain tool, Drive chain maintenance tools

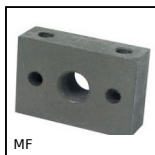

MF

Shock Absorber-universal flange, Universal fixing



BEAB

Knob star grip antibacterial, Star, anti-bacterial



SSB

Stainless steel bevel gear, 1:1



INS

Self tapping steel insert, Steel

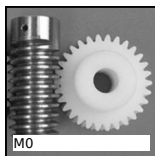

M0

Worm and wheel set, Machined plastic (delrin)

## Complementary products



CHAPAMss

Weld-on hinge with flat end, Stainless steel or Aluminium