

Miniature friction hinge

Faible
XS

CHAFRMINI

POM black or white

- Screw-on front hinge
- Opening angle 270°
- Materials:
 - White or black acetal
 - 304 stainless steel pin
- Tested for 20,000 open/close cycles

Advantage

- Miniature hinge, space saving
- Hold a door in position thanks to its self-locking system

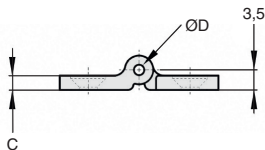
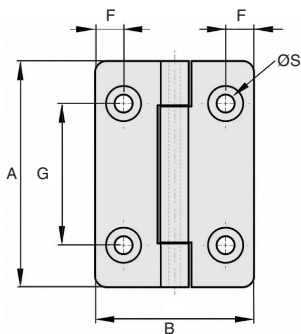
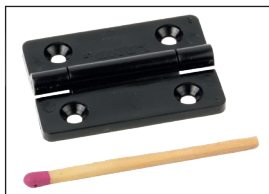

DISCOUNTS

Qty	1+	6+	20+	50+
Disc.	Net	-5%	-10%	On request

Part N°	Colour	A	B	C	ØD	F	G	ØS	Friction torque (Nm)	Weight (g)	Stock*	Price each
CHAFR4028/MIN/B	Noir	40	28	2,5	2	5	25	3,2	0,25	5	-	10,82 €
CHAFR4028/MIN/W	Blanc	40	28	2,5	2	5	25	3,2	0,25	5	-	10,82 €

All dimensions in mm

Our other products



Miniature motorised actuator 2A, 2 amperers



Right angled gearbox, from 4 to 10.30 Nm



Stainless steel hexagonal headed thumb nut, Lobed handscrew



Fixable foot for the food industry, Stainless steel - 3-A standard



Cable-carrier chain for aluminium profile, Supplied in metre lengths



Needle roller universal joint - Stainless steel, Heavy duty DIN808-7...



Cylindrical bronze nut, Bronze - 2 threads



Stainless/Polymer pillow block bearing, Polymer and stainless steel



Closed linear precision bearing,

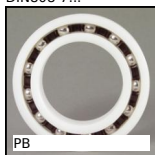

Plastic deep groove ball bearing, Plastic -



Articulated levelling foot, pressed base



Moulded plastic bevel gear (nylon), 1:1

Complementary products



Miniature friction hinge, Friction



Adjustable friction hinges, Friction