

★★★★ Stylish stainless steel screw hinge

CHAEss

316 stainless steel

- **Screw hinge**
- For right and left mounting
- 180° opening angle
- Fixed using countersunk screws (M5, M6 or M8 according to DIN 7991)
- The visible surface of the hinge has polished satin finish
- **Material:**
100% 316 stainless steel

Pin non-accessible

Impenetrable



Advantages

- Stylish visual appearance as the pin is not visible
- Vibration proof
- Vandal proof thanks to welds over the pin at both ends.

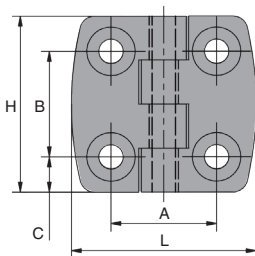
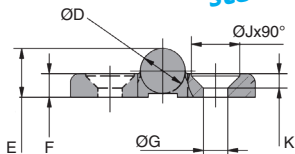

✓ IN STOCK*
Otherwise contact us

DISCOUNTS

Qty	1+	6+	20+	50+
Disc.	List	-5%	-10%	On request

Part number	H	L	A	B	C	ØD	E	F	K	ØG	ØJ	Stock*	Price each 1 to 5
CHAE4042/SS	40	42	25	25	7,5	10,2	10,6	5	3,0	5,2	10,2	✓	30,86 €
CHAE5050/SS	50	50	30	30	10,0	12,0	12,5	6	3,7	6,2	12,4	✓	34,87 €
CHAE6063/SS	60	63	36	36	12,0	15,3	16,6	8	4,9	8,3	16,5	-	41,76 €

*Depending on availability - Dimensions in mm

HPC WEB 2017

www.hpceurope.com - Tel: +33(0)4 37 496 496

Our other products



CF
Cam follower,
Standard - steel



BLHB20
Right angled gearbox,
bored shafts, up to
1.77 Nm



BABA
Ball pin lifting ring,
Steel



GMK17_RG
Joint for guiding
profile, Rounded



R205
Die spring ISO10243,
Heavy



PRF_GAL
Roller for aluminium
profile, Fixing kit for
roller concentric



CDGamme
Compression spring
DIN2095, DIN 2095



GSI_A
Stainless steel
adjustable gas spring,
Stainless steel



NKIB
Combined bearing
with inner ring, Axial



OPFL_OPPM
Numerical counter
accessories,



E20
Right angle helical
reducers, from 0.60 to



AC
Strike for toggle latch,
12,13,18 and 20mm

Complementary products



CHAE3030PA
Square decorative
screwed hinges,
Polyamide



CHAE6555
Decorative screwed
hinge, Aluminium



CHAEpac
Square decorative
screwed hinges,
carbon fibre
reinforced



CHA1056_U4
Screw-in hinge,
Section 40X40