

★★★★ Stylish stainless steel screw hinge

CHAEss

316 stainless steel

- **Screw hinge**
- For right and left mounting
- 180° opening angle
- Fixed using countersunk screws (M5, M6 or M8 according to DIN 7991)
- The visible surface of the hinge has polished satin finish
- **Material:**
100% 316 stainless steel

Pin non-accessible

Impenetrable



Advantages

- Stylish visual appearance as the pin is not visible
- Vibration proof
- Vandal proof thanks to welds over the pin at both ends.

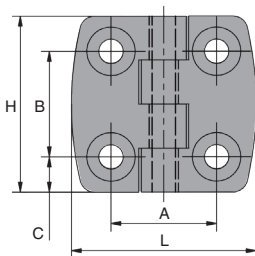
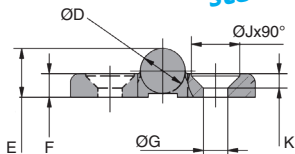

✓ IN STOCK*
Otherwise contact us

DISCOUNTS

Qty	1+	6+	20+	50+
Disc.	List	-5%	-10%	On request

Part number	H	L	A	B	C	ØD	E	F	K	ØG	ØJ	Stock*	Price each 1 to 5
CHAE4042/SS	40	42	25	25	7,5	10,2	10,6	5	3,0	5,2	10,2	✓	30,86 €
CHAE5050/SS	50	50	30	30	10,0	12,0	12,5	6	3,7	6,2	12,4	✓	34,87 €
CHAE6063/SS	60	63	36	36	12,0	15,3	16,6	8	4,9	8,3	16,5	-	41,76 €

*Depending on availability - Dimensions in mm

HPC WEB 2017

www.hpceurope.com - Tel: +33(0)4 37 496 496

Our other products



PRF_SDD

Support for $\varnothing 12\text{mm}$
Prox detector, $\varnothing 12$



PRF-SRA

Lock for aluminium
profile, Lock

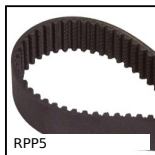

RPP5

RPP heavy duty
timing belt, RPP5



CAP815

Slim slat top chain
stainless steel,
Narrow range 815



WJUM10

Drylin® W bearing
block, Slide

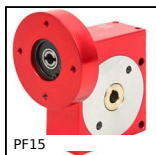

PF15

Worm and wheel gear
reducer, up to 3,75
Nm



P45

Worm and wheel gear
reducer, up to 40 Nm



PAS

Pull handle,
Reinforced PA
thermoplastic



DZYSS

Stainless steel
cylindrical stop,
stainless steel



AC156-157

Strike for toggle latch,
25.5mm



P70

Worm and wheel gear
reducer, up to 164
Nm



H02SS

Needle roller universal
joint - Stainless steel,
Heavy duty
DIN808-7...

Complementary products



CHAE3030PA

Square decorative
screwed hinges,
Polyamide



CHAE6555

Decorative screwed
hinge, Aluminium



CHAEpac

Square decorative
screwed hinges,
carbon fibre
reinforced



CHA1056_U4

Screw-in hinge,
Section 40X40