



Square hinge with riveted pin, **not drilled**

Sheet metal with rolled knuckle **CHAC-NP**

- Hinge for plug door
- Riveted pin, leaves not offset
- Material:
 - CHAC-NP:** Steel hinge
 - CHAC-NP/SS:** Stainless steel 304
- Natural finish

Advantages

- Economic hinge

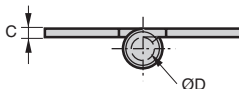
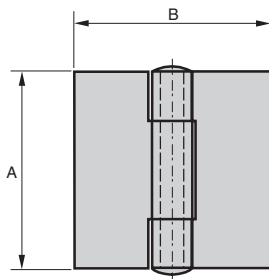

DISCOUNTS

Qty	1+	6+	20+	50+
Disc.	List	-5%	-10%	On request

Part number	A	B	C	ØD	Weight (g)	Stock*	Price each
						1 to 5	
Steel							
CHAC4040-NP	40	40	2	4	34	✓	8,69 €
CHAC5050-NP	50	50	2	6	61	✓	10,68 €
CHAC6060-NP	60	60	2	6	82	✓	11,80 €
Stainless steel							
CHAC4040-NP/SS	40	40	2	4	34	✓	14,69 €
CHAC5050-NP/SS	50	50	2	6	61	✓	16,85 €
CHAC6060-NP/SS	60	60	2	6	82	✓	19,03 €

*Depending on availability - Dimensions in mm

Our other products



WS20
Drylin® W rail, Rail



BFDd11
Locking pin for bushes, Nickel-plated steel



TCL-CR
T-Clip - Aluminium profile attachment, Magnetic object holder



ACLBD8
Closing mechanism for aluminium profile, Dual ball catch



BG
Oldham coupling, With set screw



APB_T
Adjusting rod for clamp - Female, Bored



PLM-20SC
Cylindrical magnet, Cylindrical magnet



RPCtcss
Swivel castor with central hole, Stainless steel - Polyamide - with ...



DER63
Stainless steel AC asynchronous motor 0.18 kW, 0.18kW

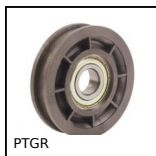

PTGR
Tensioner pulley, For round belts



P30
Worm and wheel gear reducer, up to 8.80 Nm



RBGtc
Swivel castor with central hole, Steel - grey rubber - with double b...

Complementary products



CHAC4040NP
Square hinge with riveted pin, not drilled, Square with riveted pin, ...



CHAC4040SS
Square hinge with riveted pin, drilled, Square with riveted pin, dri...